

C20

Partition



Installation illustrate

Web : <https://www.mwworkstation.com/>

Tel : +86 13695211636

Mail : robbor@mwworkstation.com

C20

Partition



FAST AND CONVENIENT INSTALLATION SYSTEM
DESK SYSTEM SCREEN SYSTEM

PRODUCT

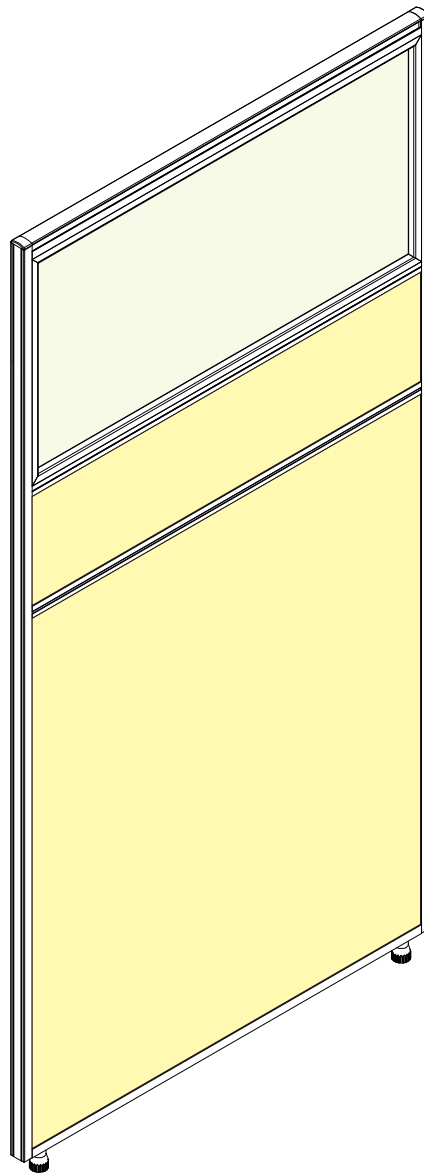

Aluminum profiles parts

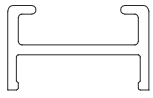

A pole
7303#

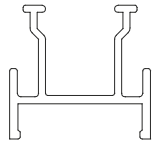

Top bar
7307#



Top cover
7306#

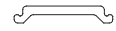

Side cover
7304#

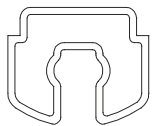

Single glass groove
7346#



Bottom bar
6853#

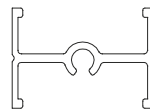

Mid bar
6856#

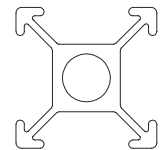

Corner pole
7308#

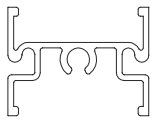

Mid bar A
6855#

Accessories parts



Top side cap

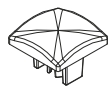

Corner pole cap

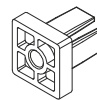

Corner pole foot

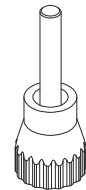

Adjustor



Corner pole panel
connector
(with M6*8 screw)



A pole panel connector

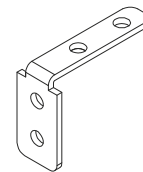

Top bar connector

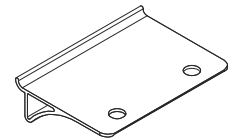

Xd318 Aluminum bracket

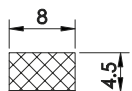

8*D435mm EVA rubber
(single side)

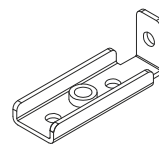

Single foot

General design character

I.C20 details:

1.Aluminum frame, block system partition

2.C20 thickness:20mm

II.End trim:

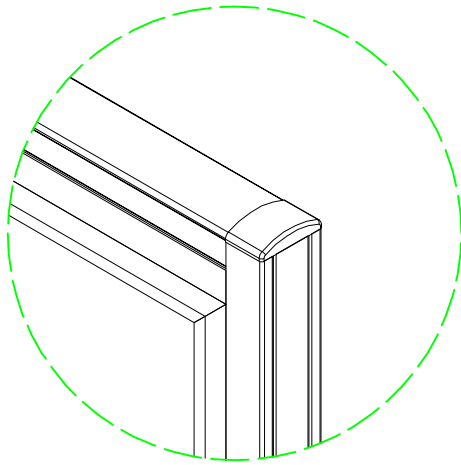

III.Corner connections:

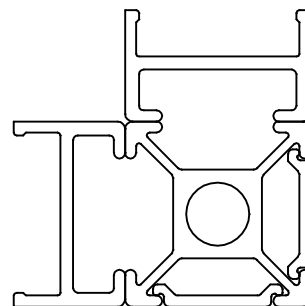
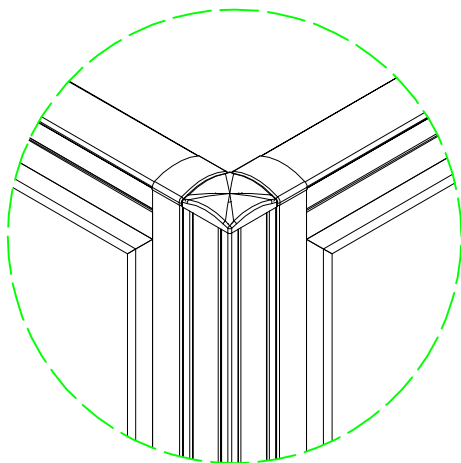

Structure

I.C20 structure details:

1. Panel-base system, aluminum frame includes powder coated and anodized.
2. Blockmaterial:(4mm)glass/polycarbonate, melamine, fabric, metal sheet, white board and accessories rail.

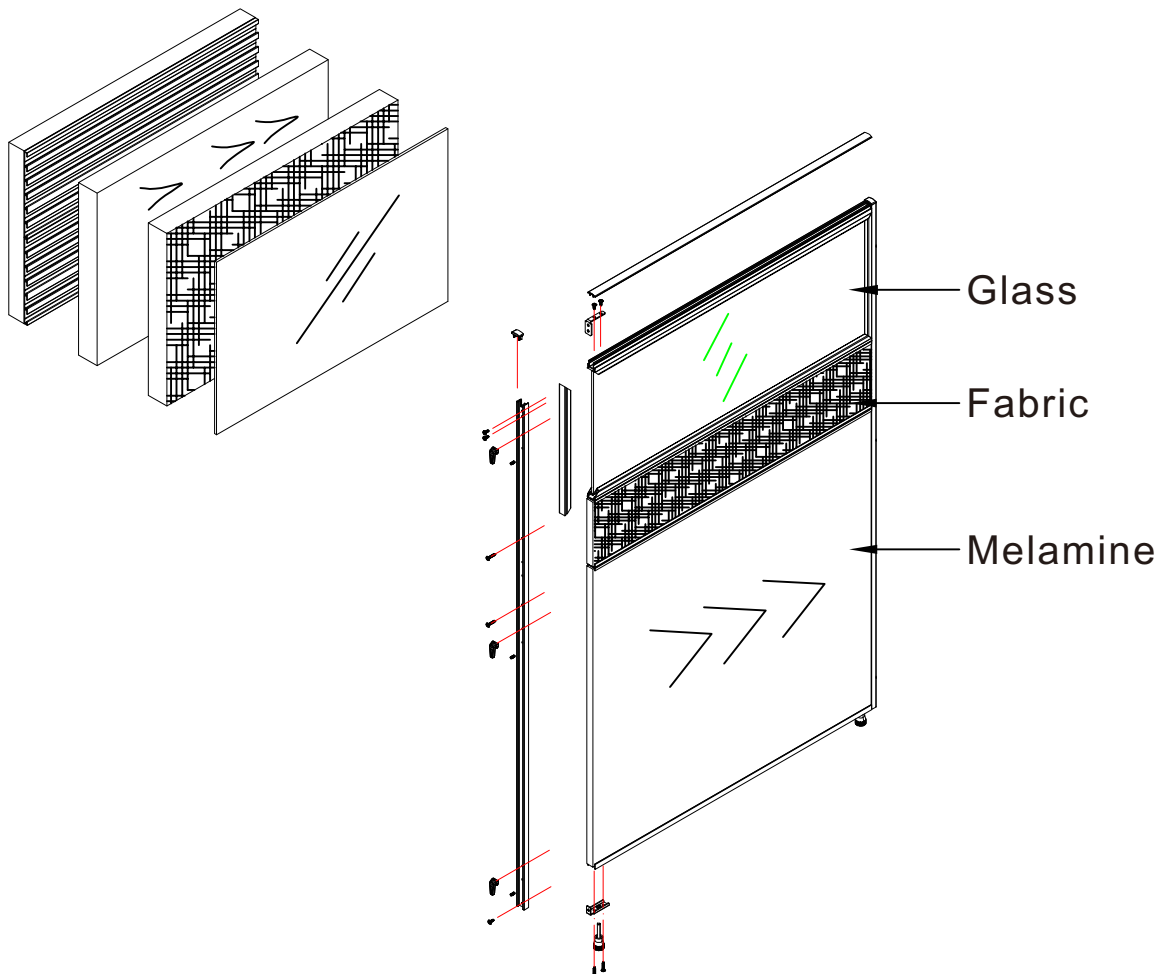

Structure

II. Panel explosion details (take L connection for example)

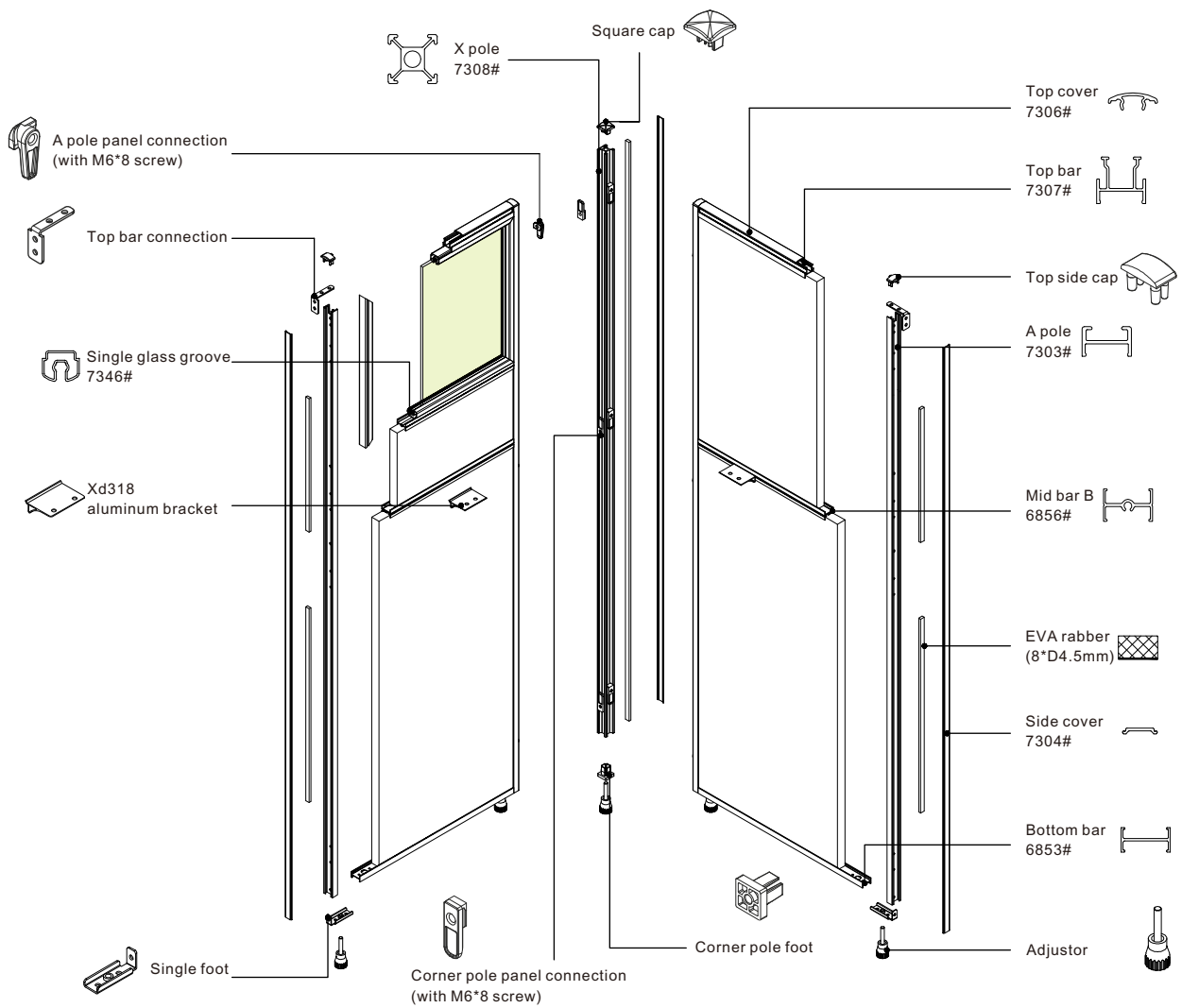

Connections

I. Between panels and poles:

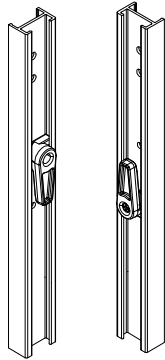

Straight connection

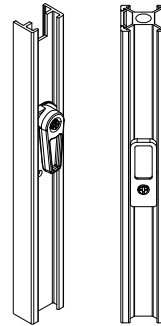

Corner connection

II. Different thickness connections (take L connections for example):

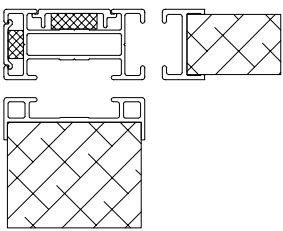

C20&C40

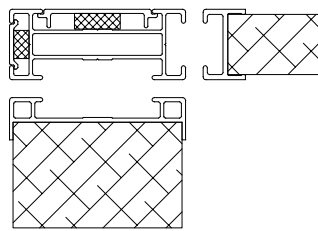

C20&C50

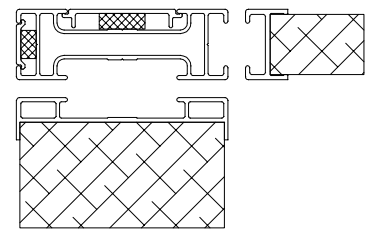

C20&C60

Supporting system

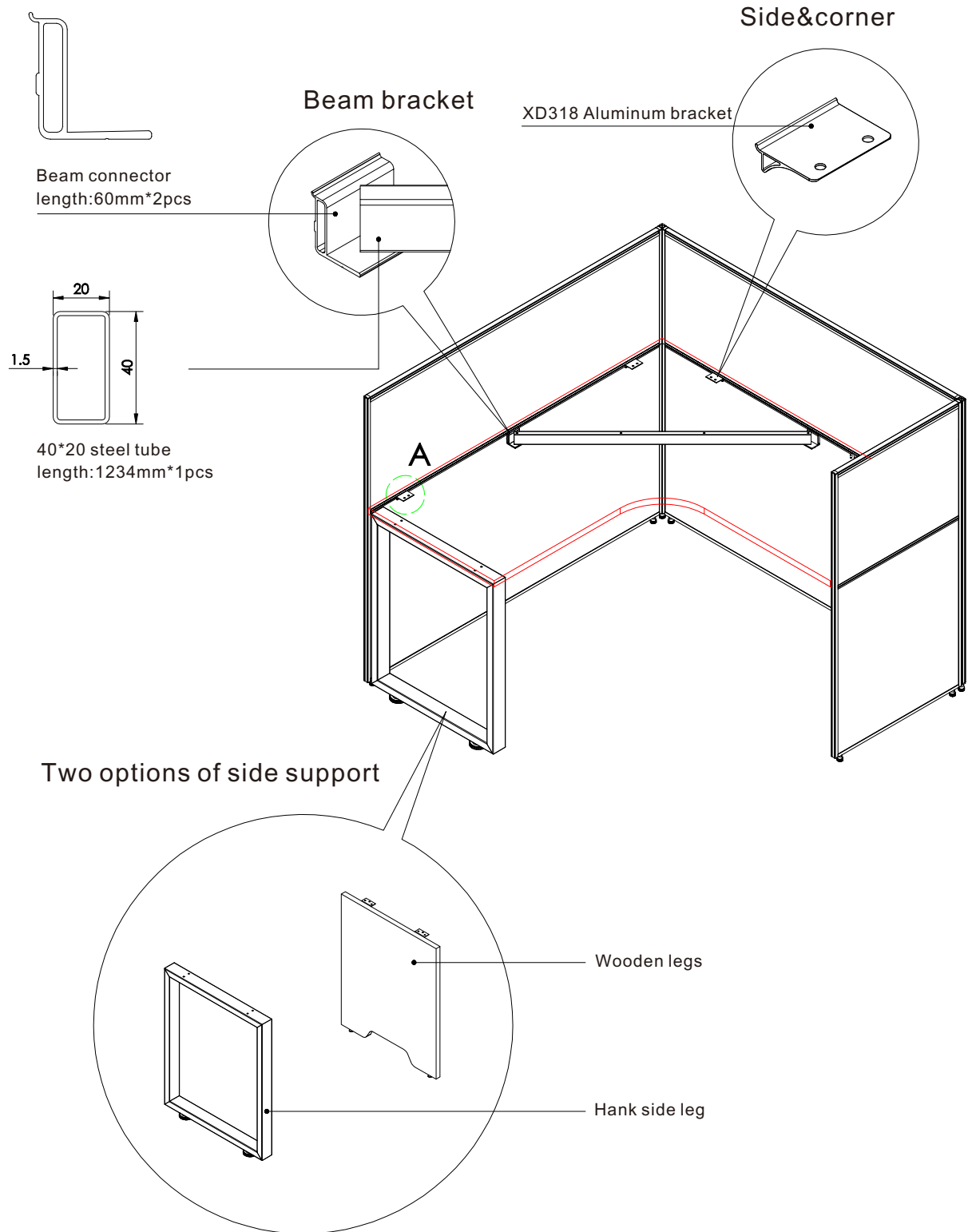

Segments details

C20 without cable segments:

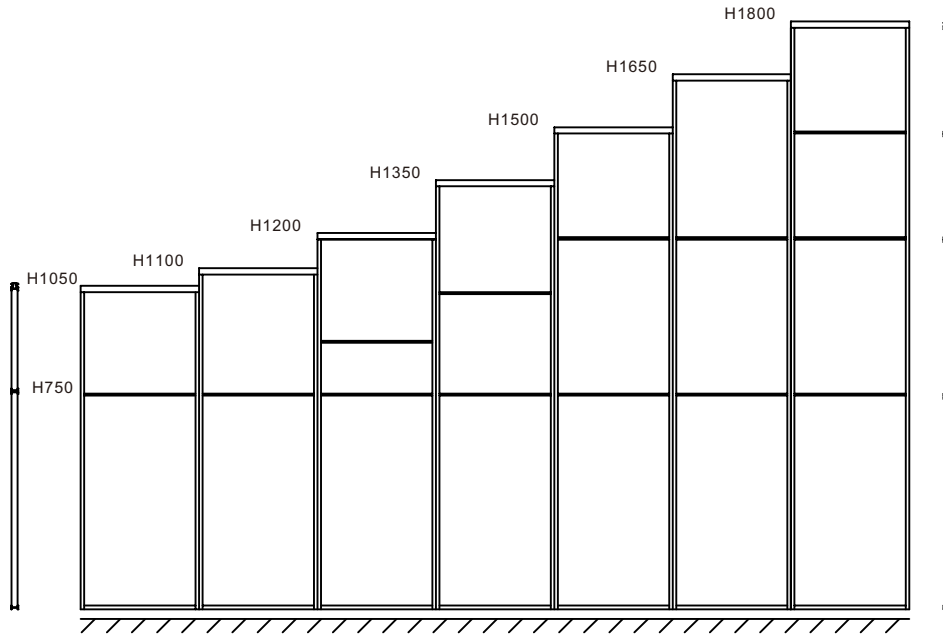

H: 1050/1100/1200/1350/1500/1650/1800 (mm).

W: 450/500/600/750/800/900/1050/1200/1400/1500/1600 (mm).

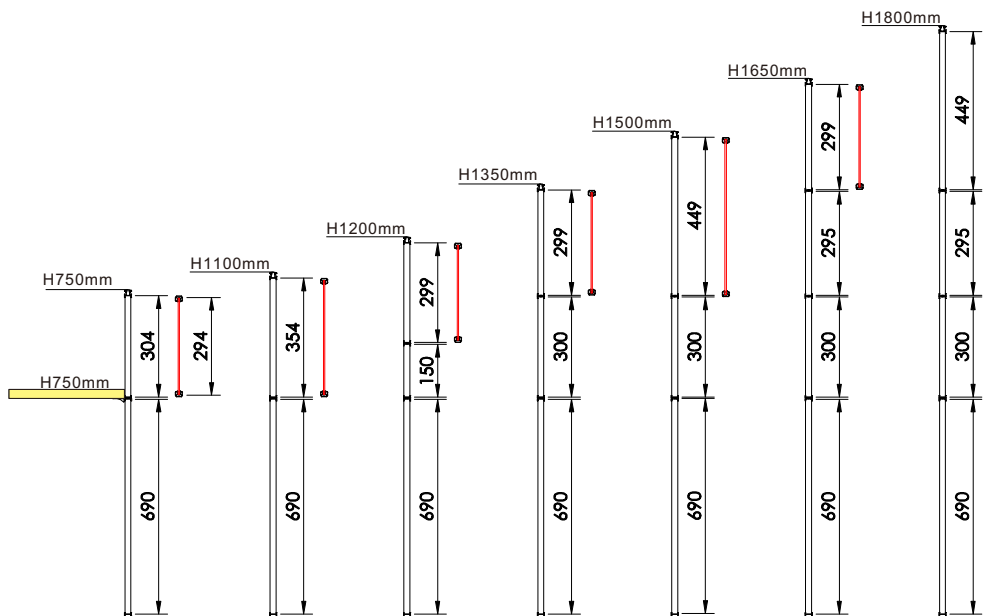

Cut lenght logics

I. Formula:

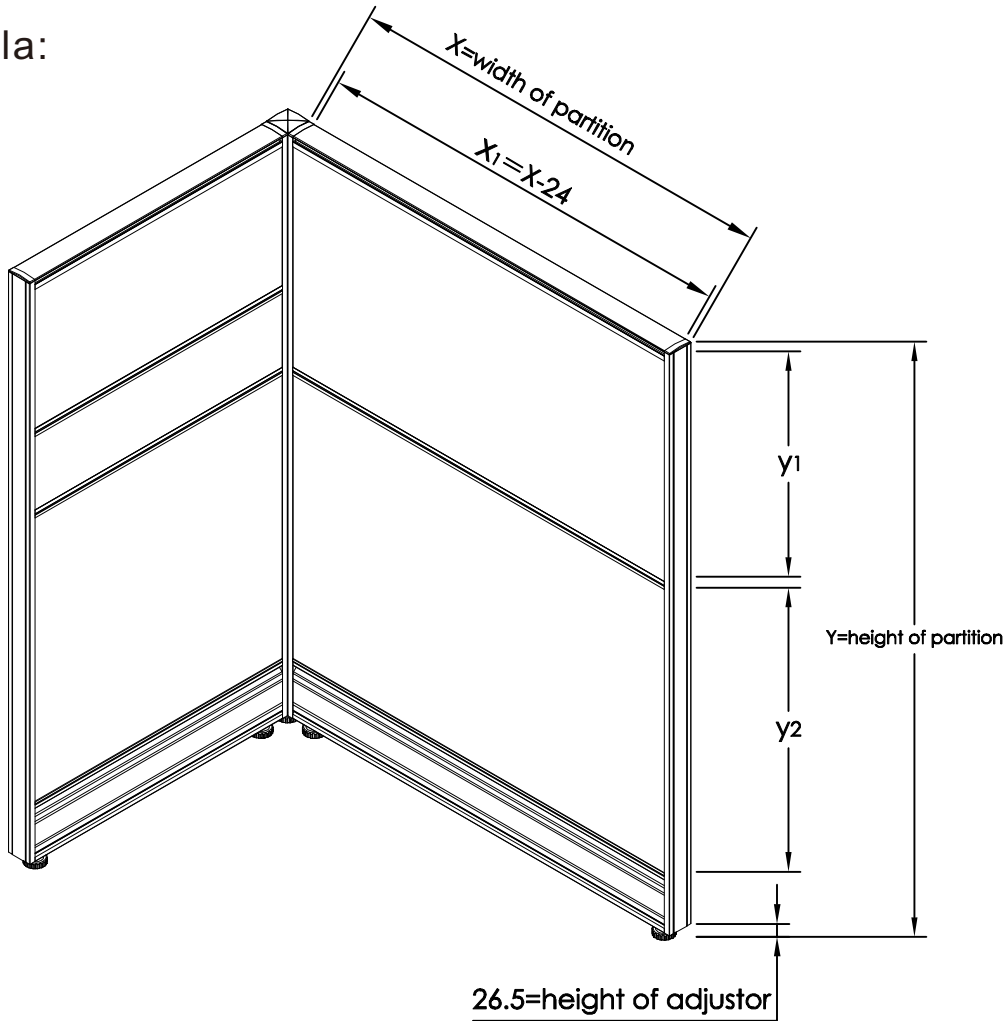

Unit:mm

Name	Code	Size	Diagram
top cover	C20.DFB.01	X-24	
top bar	C20.DG.01	X-24	
mid bar A	C20.FGZG.01	X-24	
bottom bar	C20.XG.01	X-24	
mid bar B	C20.GCZG.01	X-24	

Name	Code	Size	Diagram
A pole	C20.AZ.01	Y-31	
side cover	C20.CFB.01	Y-31	
corner pole	C20.SZZ.01	Y-31	
single glass groove	C20.XDBLC.01	Y1-10	

Cut length logics

II. Material details:

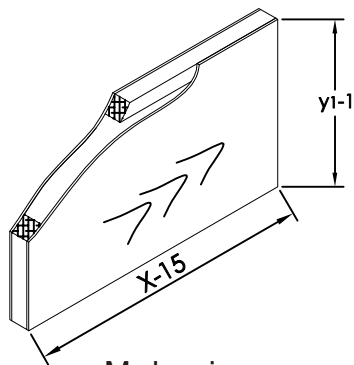

Melamine

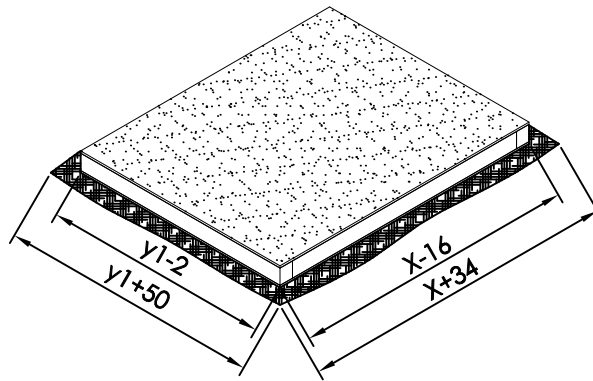

Board with fabric

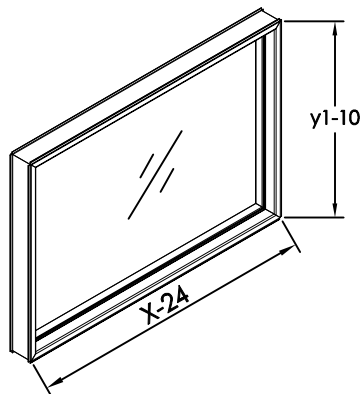

Glass frame

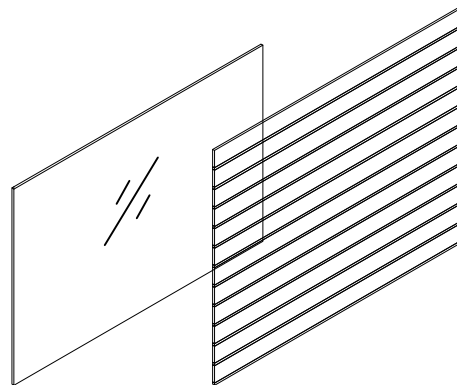

Glass

Polycarbonate

III. Block thickness C20=17mm

Holes punching

I.C20 structure details:

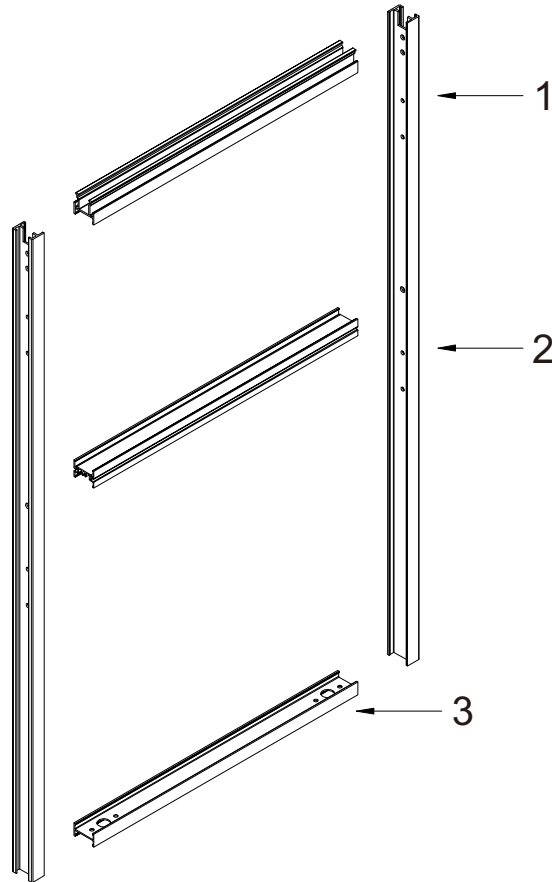

1.Mould for hole connected top bar on A pole

2.Mould for hole connected panel on A pole

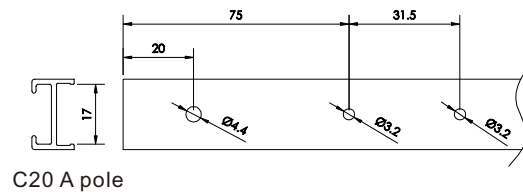
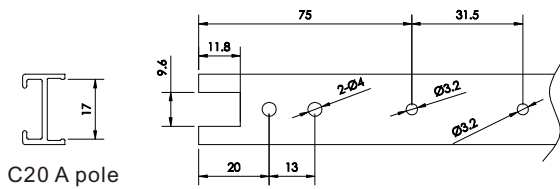

3.Mould for holes of adjustor on bottom bar

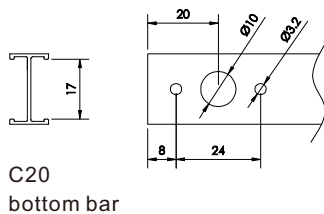

M & W

Web: mwworkstation.com

Mail: robbor@mwworkstation.com

Tel: +86 13695211636

WhatsApp: + 86 13695211636

Add: NO.3 Xingye North Road Dawotang Industrial
District Shishan Nanhai Foshan City Guangdong
P.R China



WhatsApp



Facebook



Instagram



Twitter



Pinterest



Linkein



YouTube