

C32

Partition



Installation illustrate

Web : <https://www.mwworkstation.com/>

Tel : +86 13695211636

Mail : robbor@mwworkstation.com

C32

Partition



FAST AND CONVENIENT INSTALLATION SYSTEM
DESK SYSTEM SCREEN SYSTEM

PRODUCT

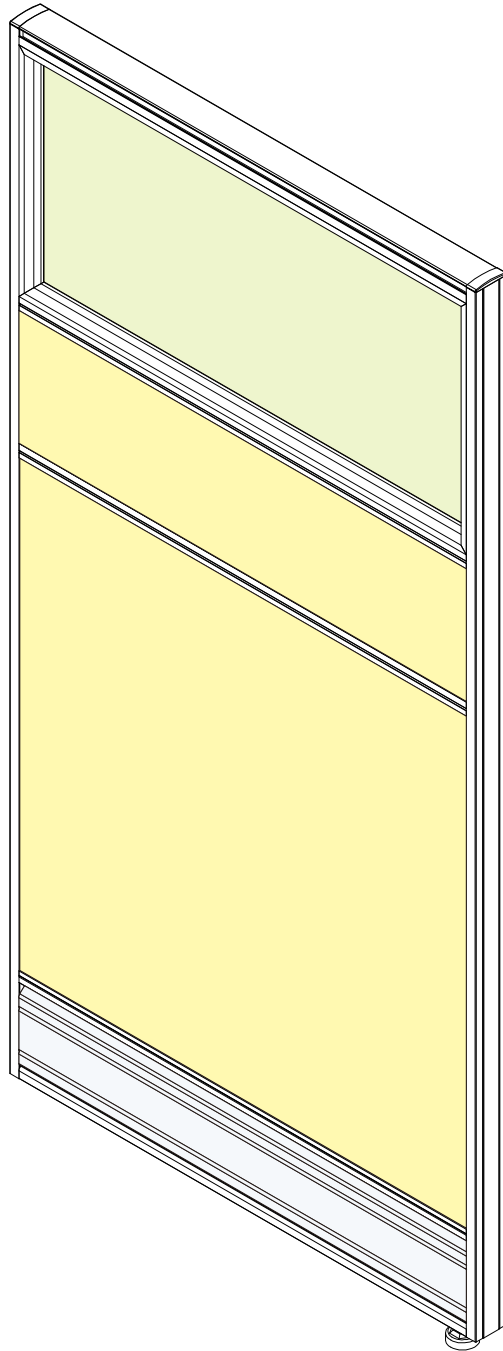

Aluminum profiles parts



A pole
7241#



Side cover
7242#



Top cover
7244#

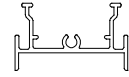

Top bar
7243#

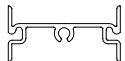

Mid bar A
6772#

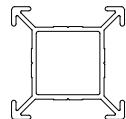

Corner pole
7249#



Single glass groove
7347#



Double glass groove
7348#

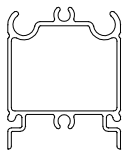

Gig mid bar
7320#

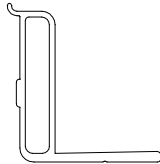

C32.DMFGHGLJJ.01
7319#

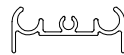

Cable bar(down)
7246#



Cable hook stabilizer
7247#



Cable bar
3569#



Mid bar B
6870#

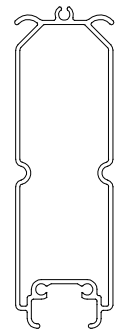

Cable hook
7248#



All-purpose Cable channel
2431#

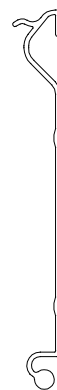

T3 cable channel
3571#

Accessories parts

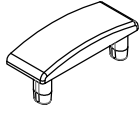

Top side cap

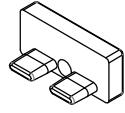

Top bar cap

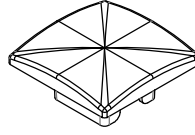

Corner pole cap

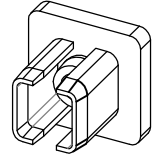

Corner pole foot



Panel connector

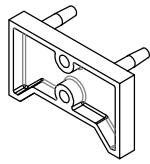

T3 cable connector

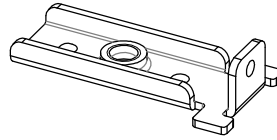

Single foot

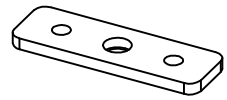

All use cable foot

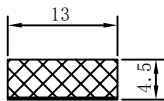

EVA rubber
(13*4.5mm)



T3 glass rubber
U9-4

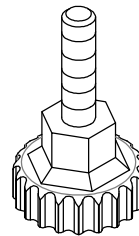

Hk32 adjustor

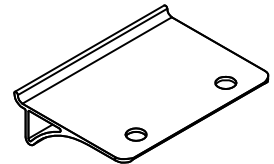

Xd318 Aluminum bracket

General design character

I.C32 details:

1.Aluminum frame, block system partition

2.C32 thickness:32mm

II.End trim:

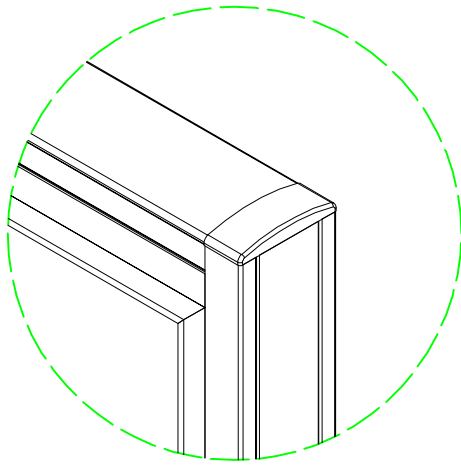

III.Corner connections:

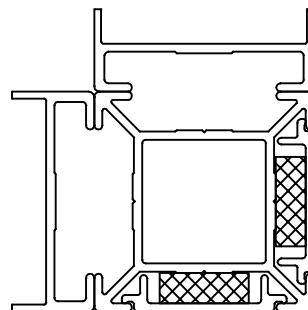
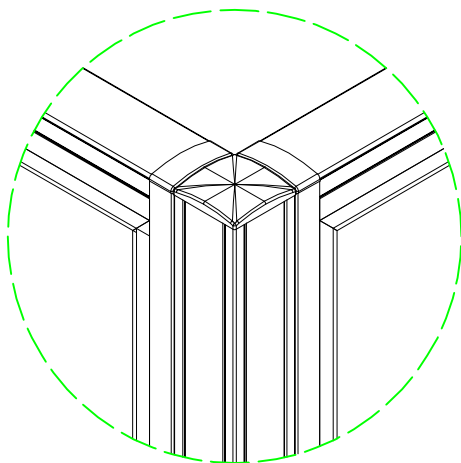

Structure

I.C32 structure details:

1. Panel-base system, aluminum frame includes powder coated and anodized.
2. Block material: (4mm) glass/polycarbonate, melamine, fabric, metal sheet, white board and accessories rail.

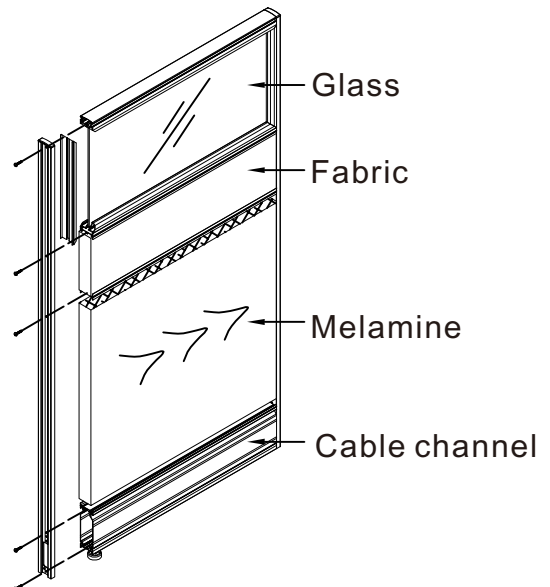
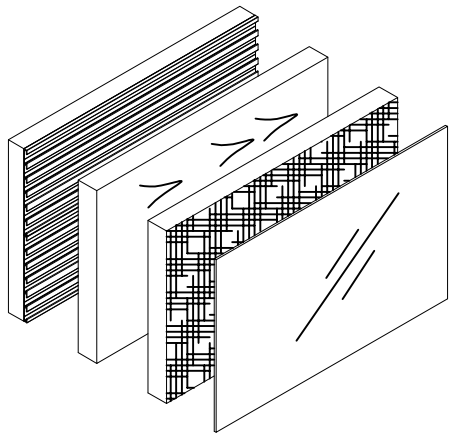

3.C32 cable channel (wire):two options.

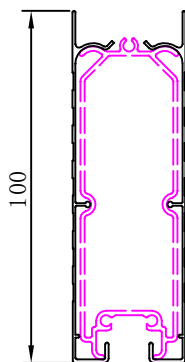

All-purpose cable channel

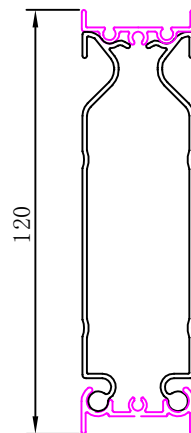

T3 cable channel

Structure

II. Capacity of cable channel

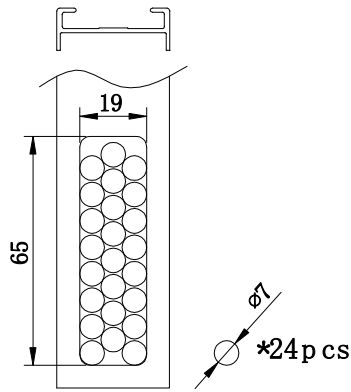

All-purpose cable channel & T3-120 cable channel

III. C32 Panel explosion details

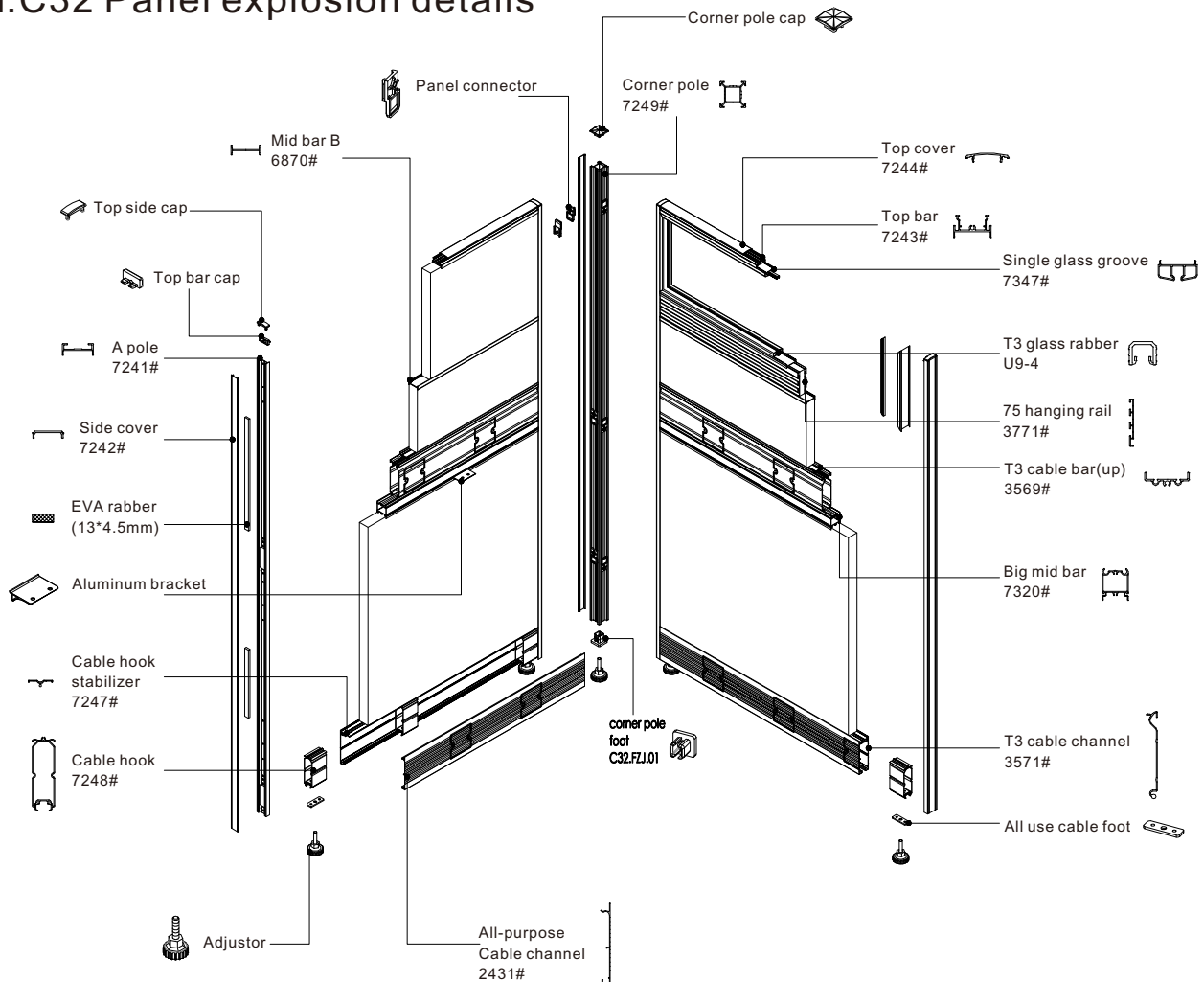

Connections

I. Between panels and poles:

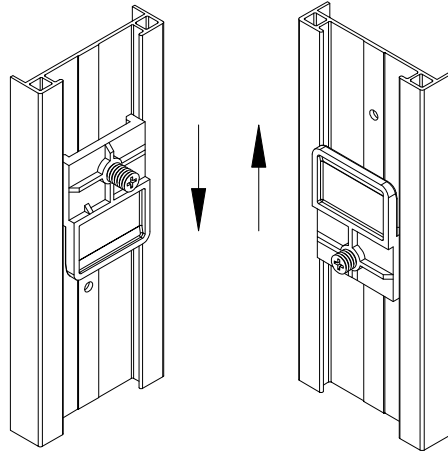

Fastening

II. Different thickness connections (take L shape for example):

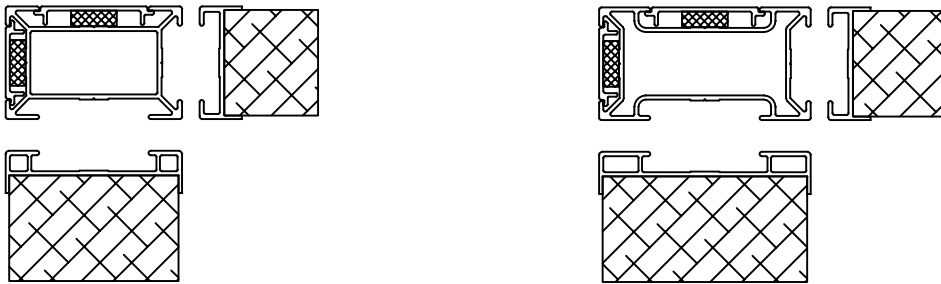

C32&C50

C32&C60

Supporting system

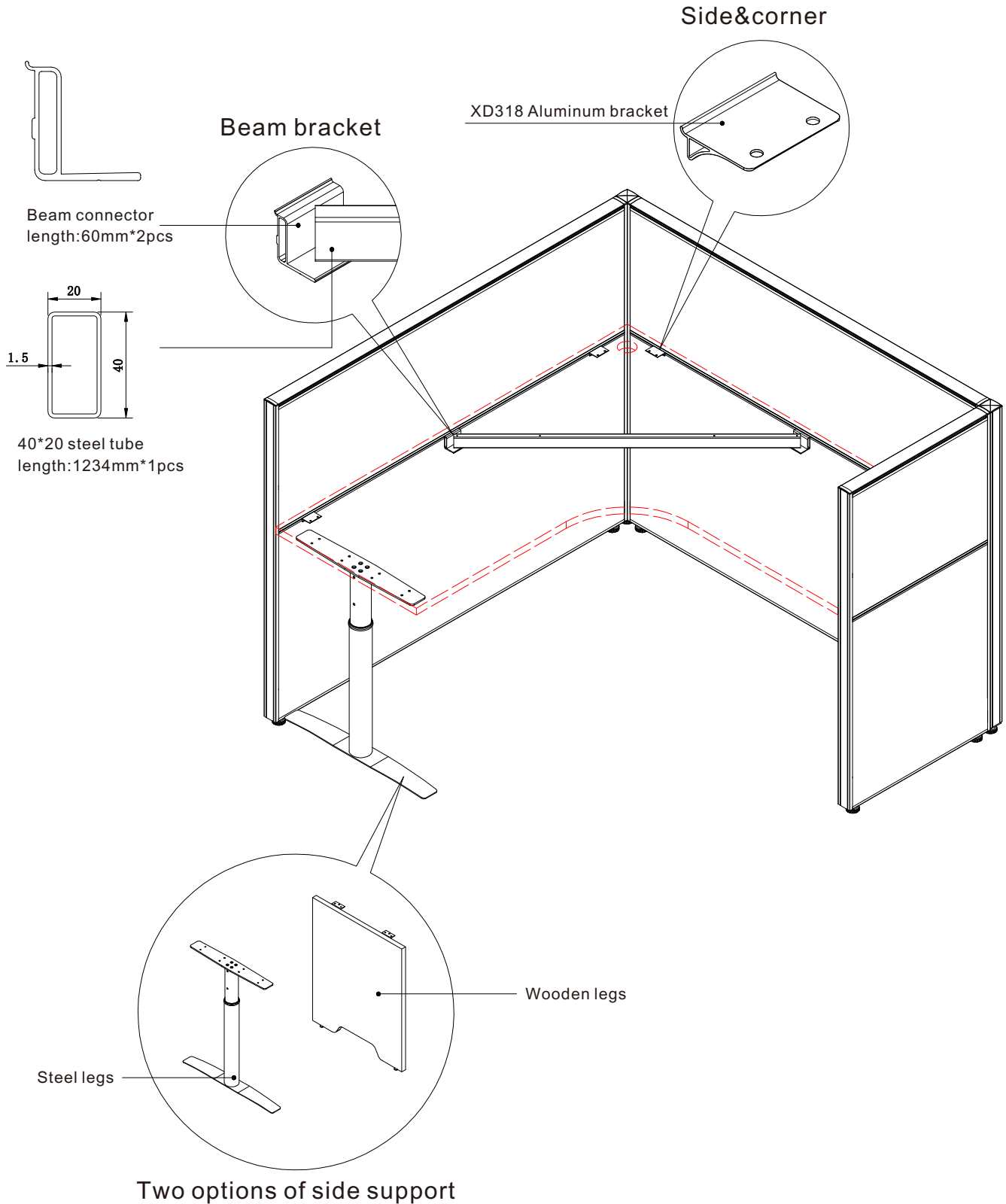

Hangings system

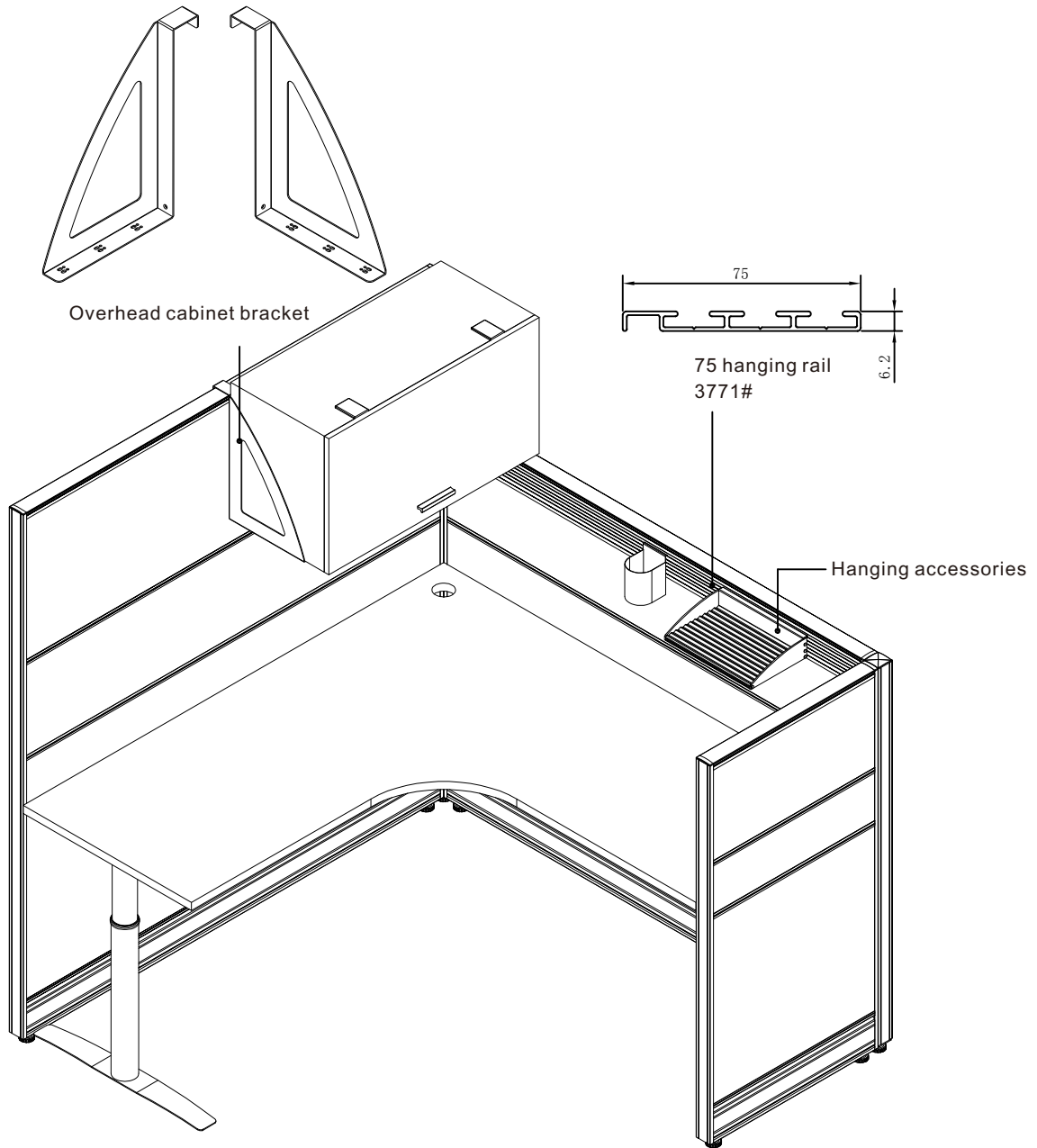

Segments details

I. Without cable channel:

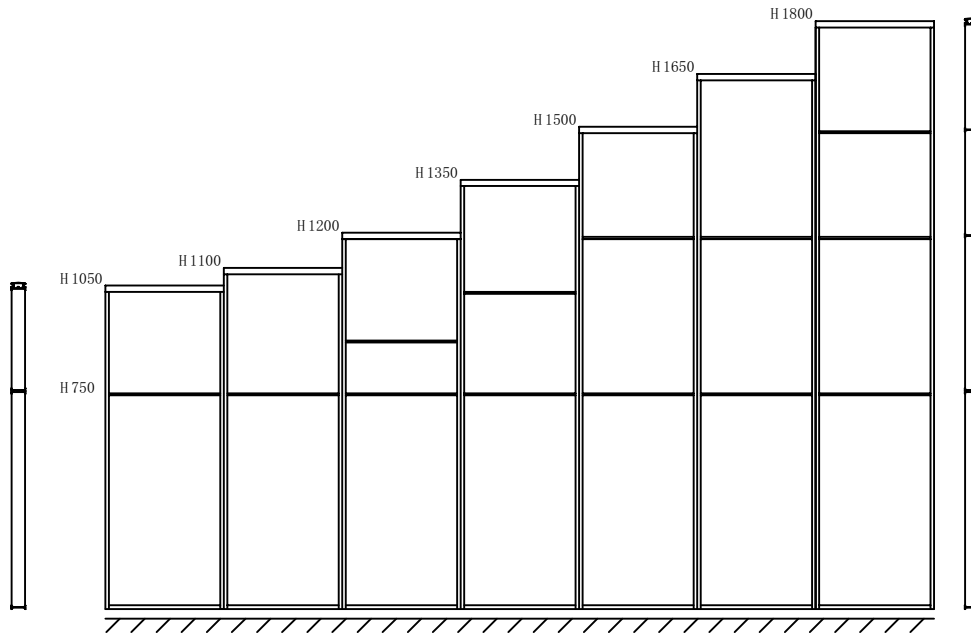

H: 1050/1100/1200/1350/1500/1650/1800 (mm).

W: 450/500/600/750/800/900/1050/1200/1400/1500/1600/1800 (mm).

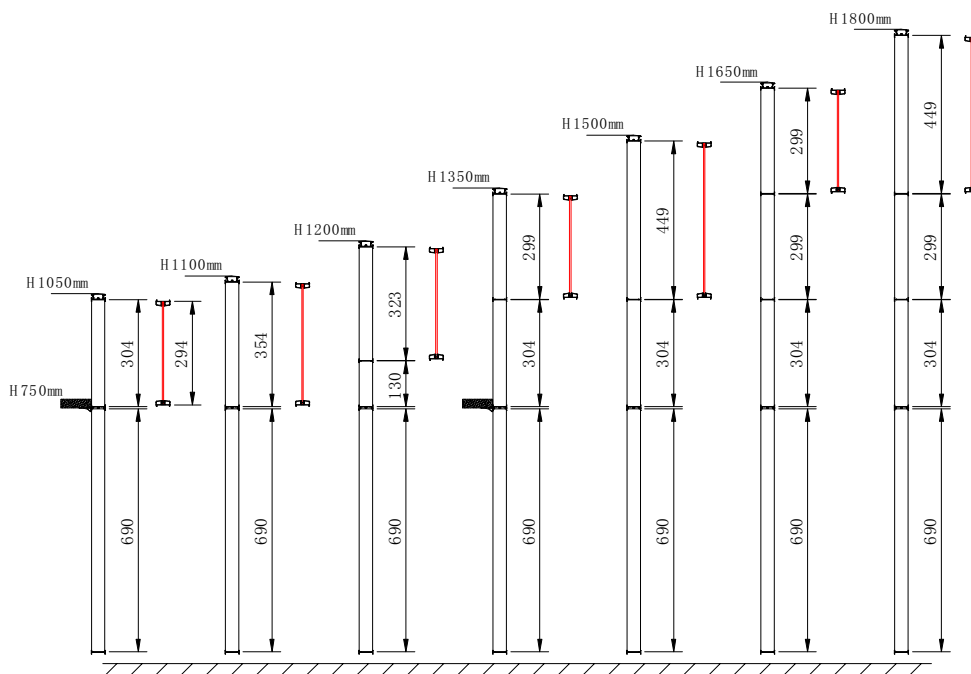

II. All-purpose cable channel on bottom:

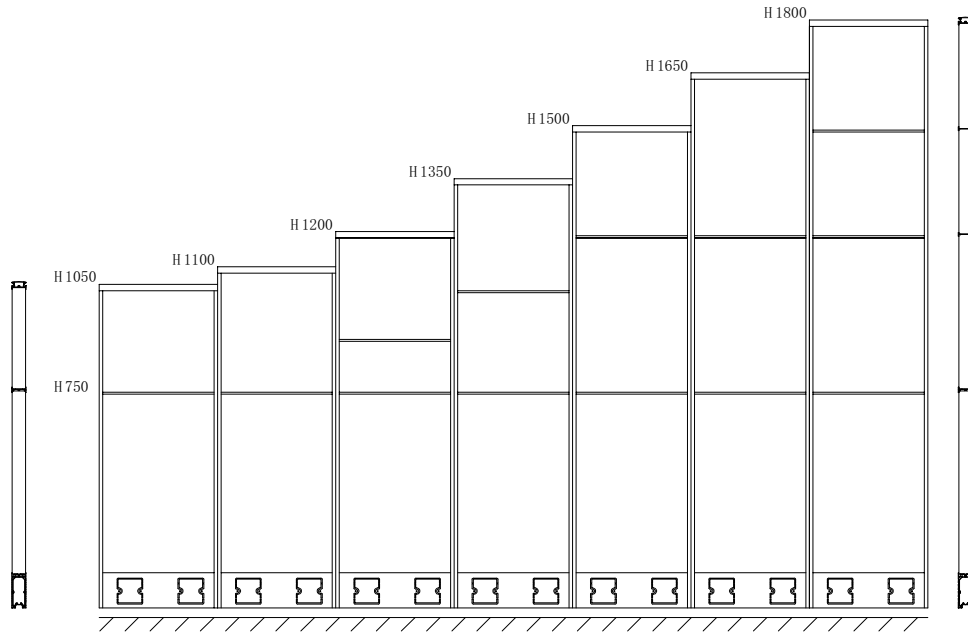

H: 1050/1100/1200/1350/1500/1650/1800 (mm).

W: 450/500/600/750/800/900/1050/1200/1400/1500/1600/1800 (mm).

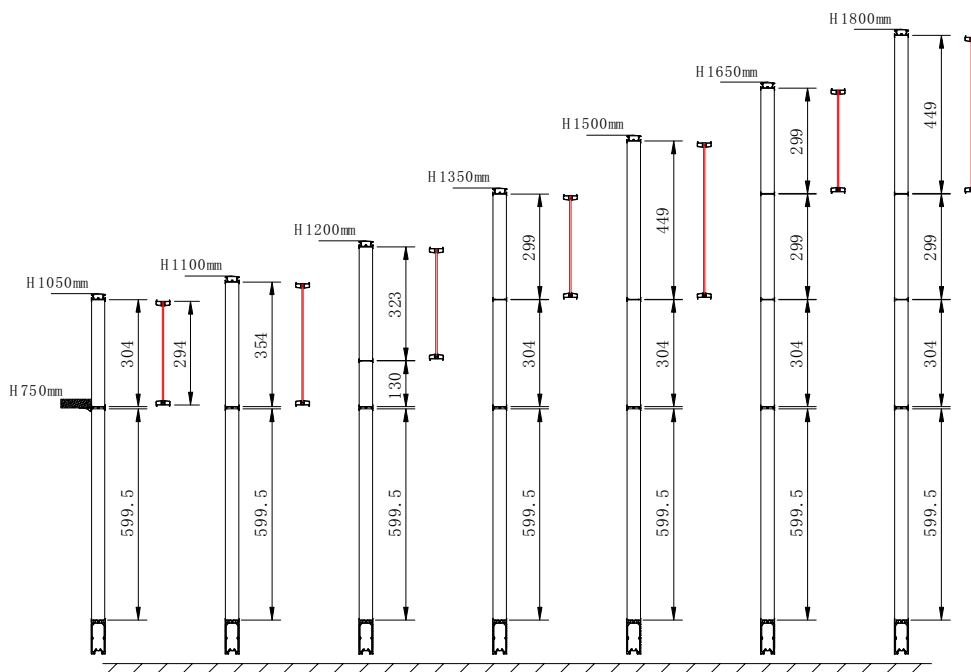

III. T3 cable channel on bottom:

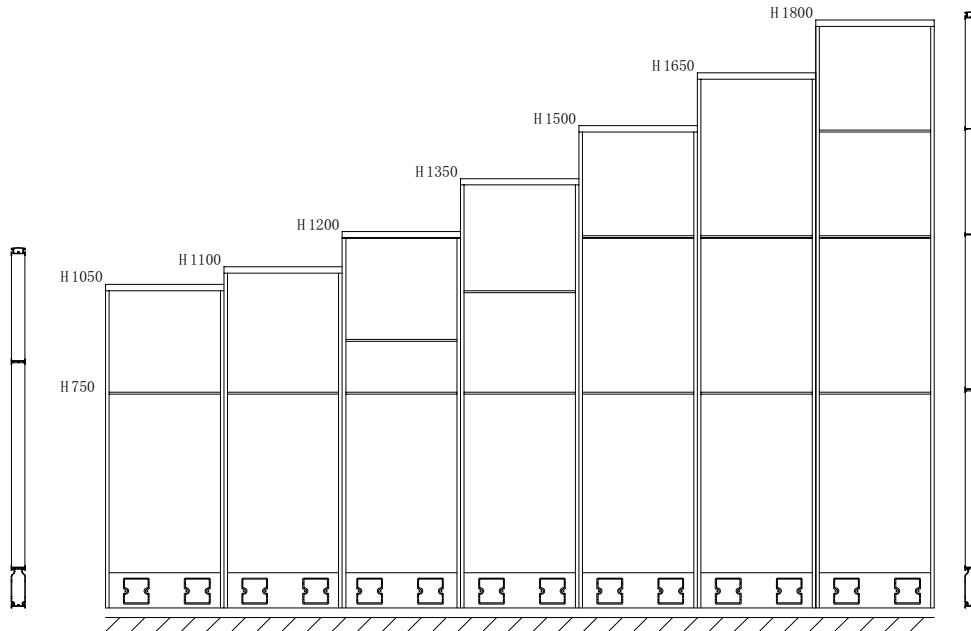

H: 1050/1100/1200/1350/1500/1650/1800 (mm).

W: 450/500/600/750/800/900/1050/1200/1400/1500/1600/1800 (mm).

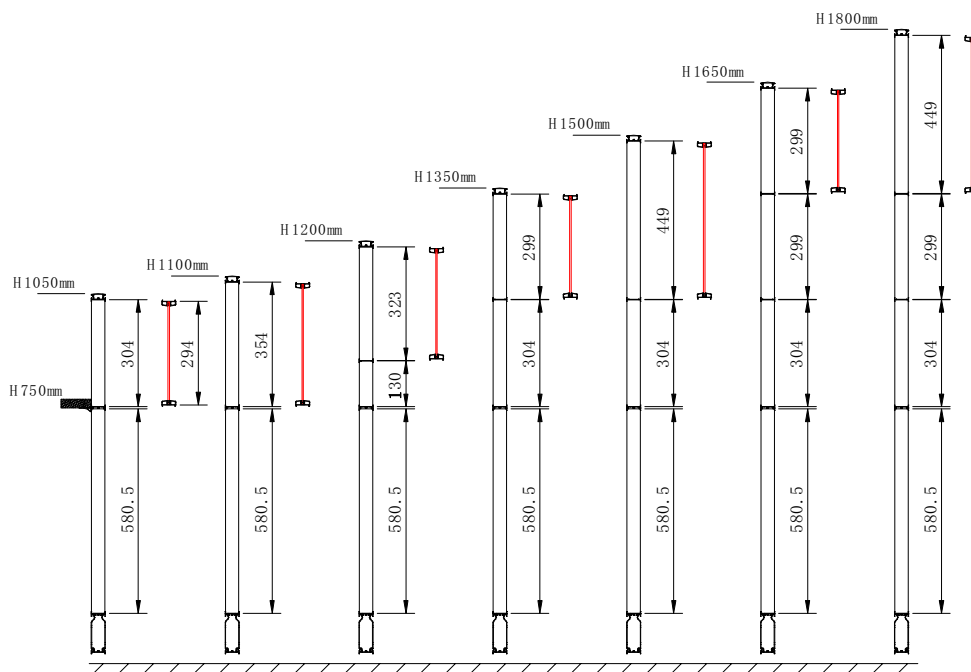

IV. Double T3 cable channel:

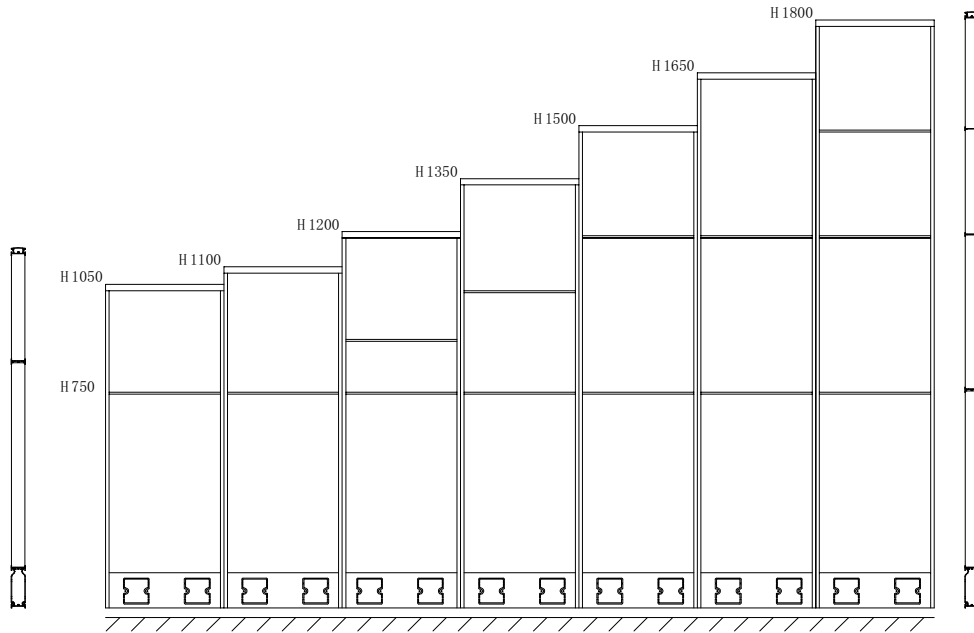

H: 1050/1100/1200/1350/1500/1650/1800 (mm).

W: 450/500/600/750/800/900/1050/1200/1400/1500/1600/1800 (mm).

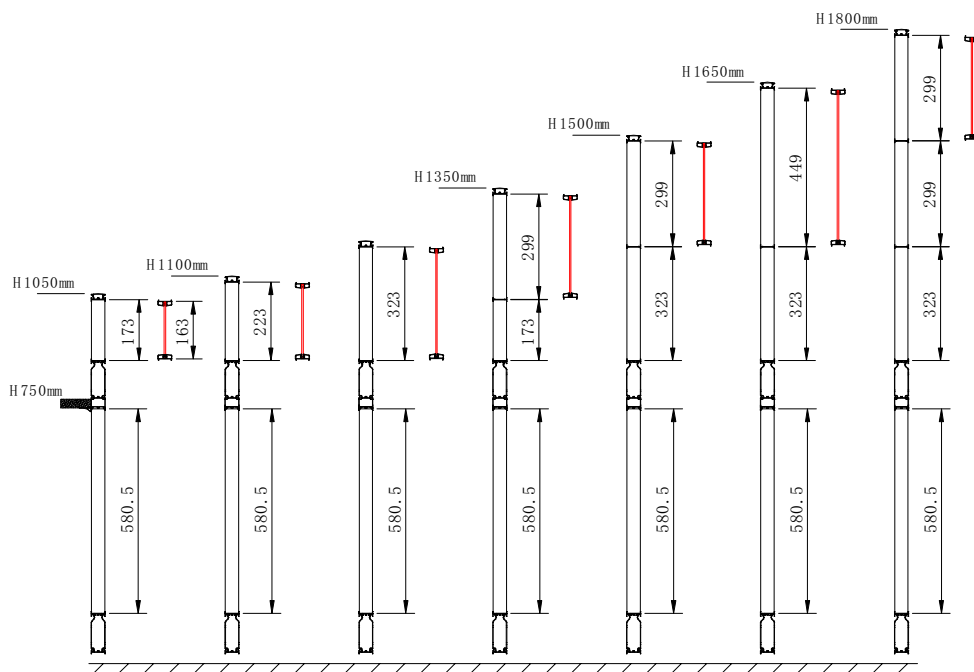

V.T3 cable channel in the mid and All-purpose cable channel on the bottom:

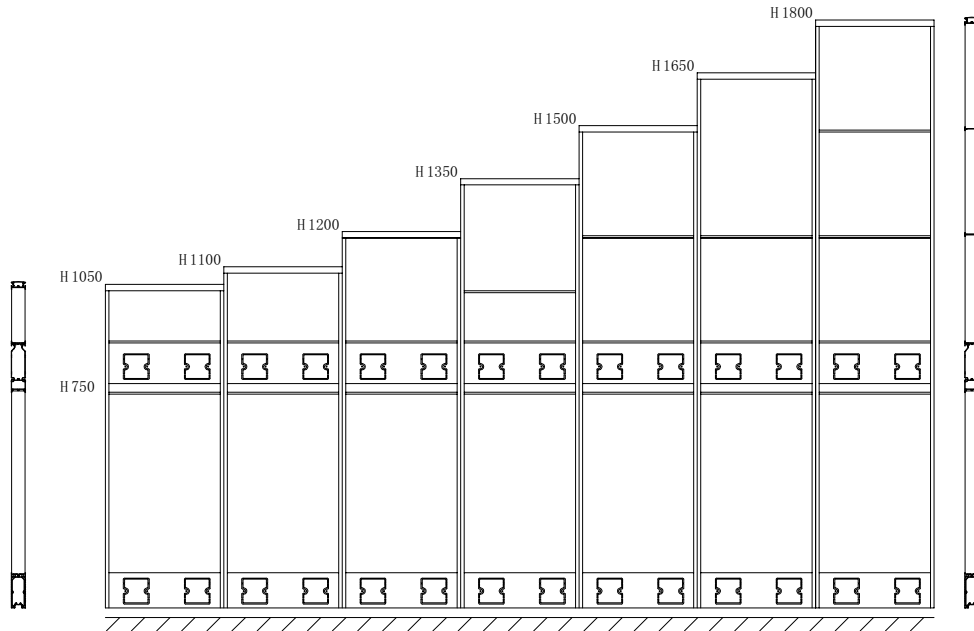

H: 1050/1100/1200/1350/1500/1650/1800 (mm).

W: 450/500/600/750/800/900/1050/1200/1400/1500/1600/1800 (mm).

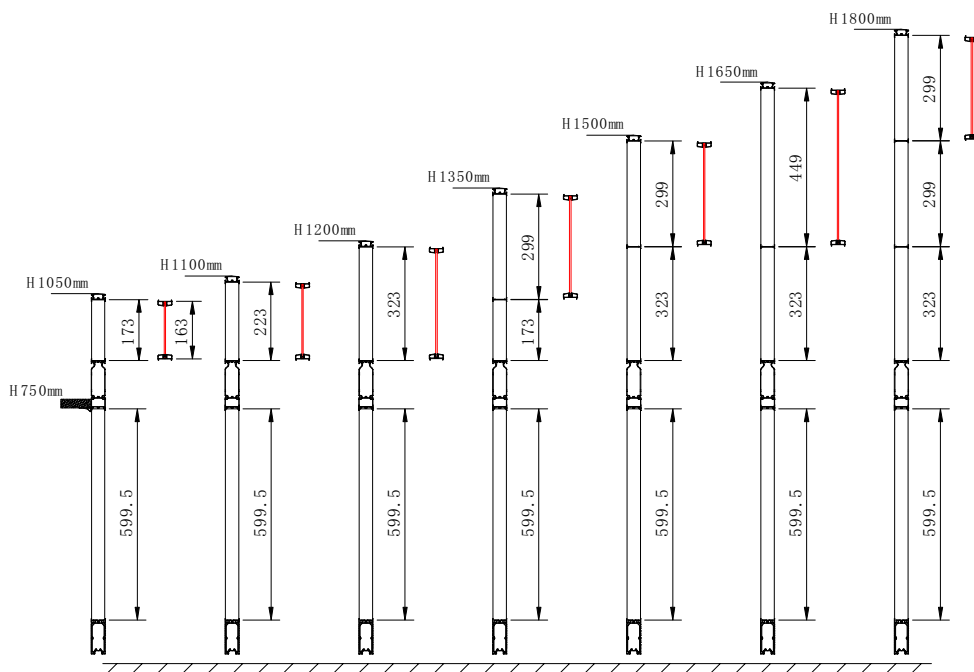

Cut length logics

I. Formula:

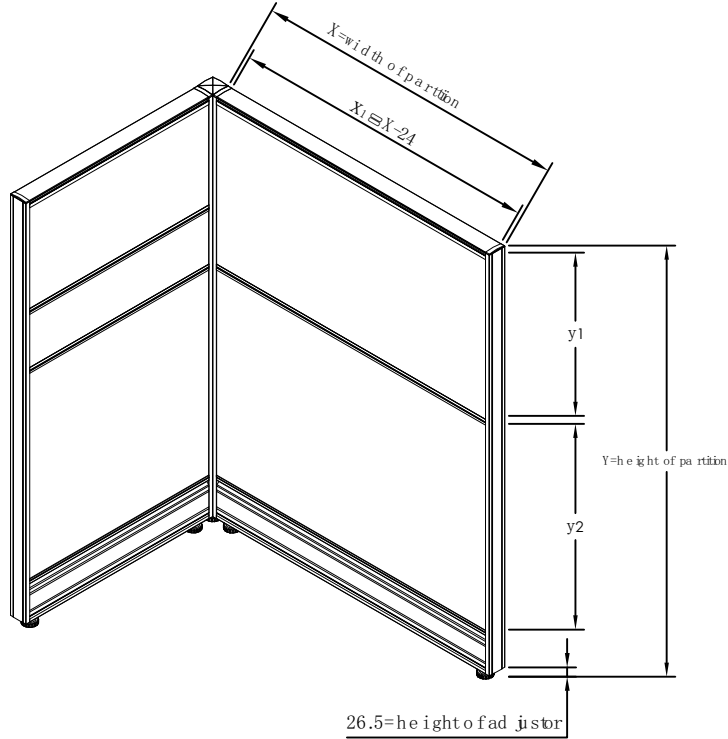

Unit:mm

Name	Code	Size	Diagram
top cover	C 32.DFB.01	X-24	
top bar	C 32.DG .01	X-24	
mid barA	C 32.FGZG .01	X-24	
mid barB	C 32.GC ZG.01	X-24	
cab le bar (up)	C 32.XC SG .01	X-24	
cab le bar (down)	C 32.XC XG .01	X-24	
cab le hook holder	C 32.TYXC G JG T.01	X-44	
big mid bar	C 32.DXC ZG.01	X-24	
cab le channel	320.XC B.01	X-24	
T3 cable channel	T3.XC B.01	X-25	

26.5=height of fastener

Name	Code	Size	Diagram
A pole	C 32.AZ .01	Y-31	
side cover	C 32.CF B.01	Y-31	
comer pole	C 32.FZ.01	Y-31	
C 50 & C 30 comer pole	C 50.50+30LJZ.01	Y-26	
single glass groove	C 32.XDBLC .01	y1=0	
single glass groove	C 32.XDBLC .01	X-24	
75a cc essors rail	C 32.75G C B.01	X-15	

Cut length logics

II. Material details:

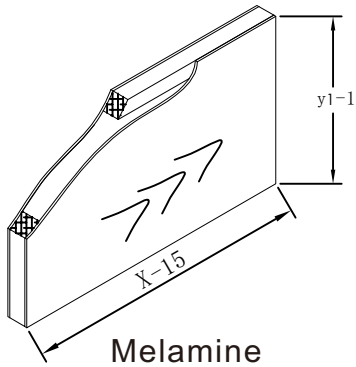

Melamine

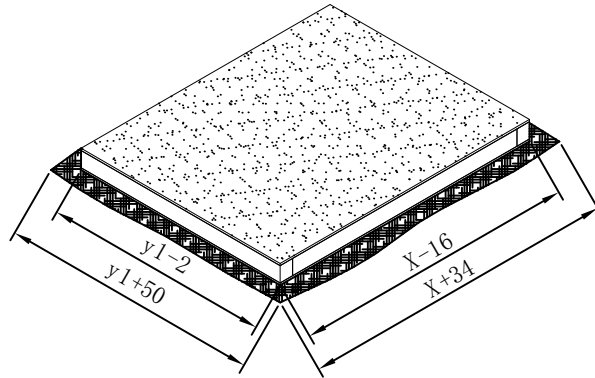

Board with fabric

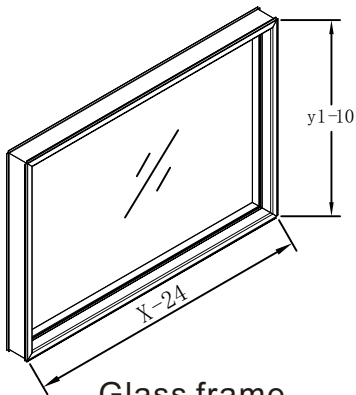

Glass frame

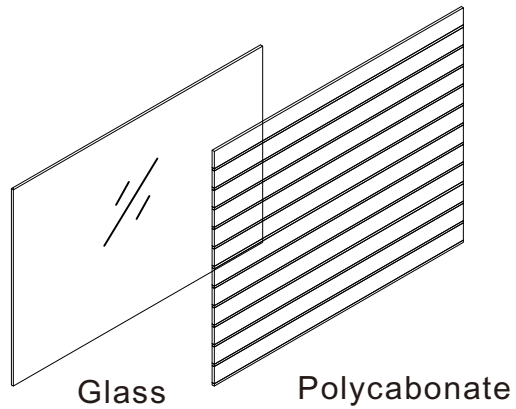

Glass

Polycarbonate

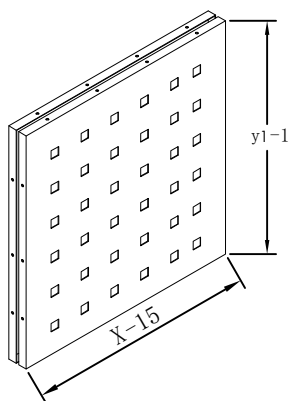

Metal block(except C20)

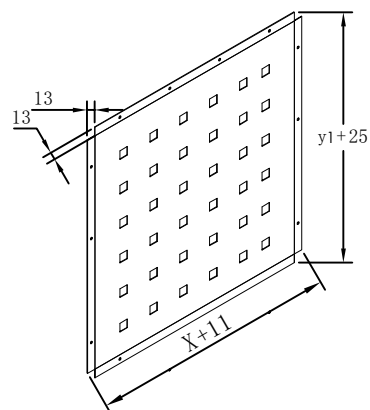

Metal sheet(before bent)

III. Block thickness C32=29.6mm

Holes punching

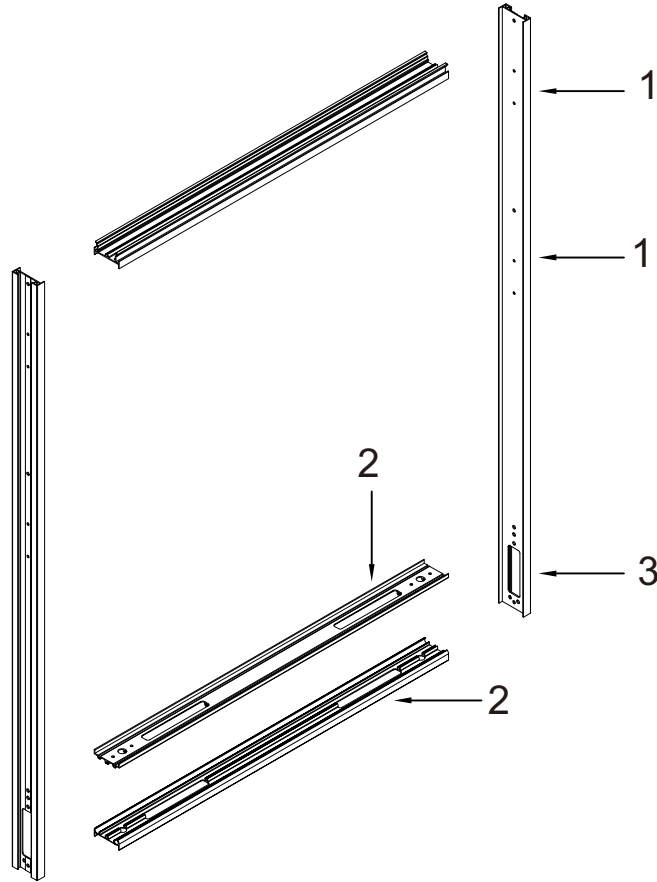

1. Mould for panel connected & top bar on A pole

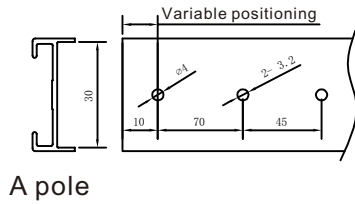

2. Mould for wire & adjustor holes on cable bar (down)

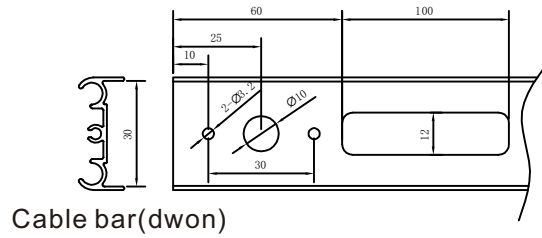

3. Mould for wire to T3 cable channel holes on A pole

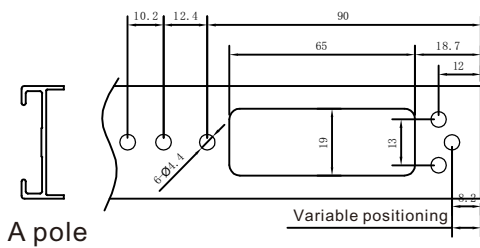

M & W

Web: mwworkstation.com

Mail: robbor@mwworkstation.com

Tel: +86 13695211636

WhatsApp: + 86 13695211636

Add: NO.3 Xingye North Road Dawotang Industrial
District Shishan Nanhai Foshan City Guangdong
P.R China



WhatsApp



Facebook



Instagram



Twitter



Pinterest



Linkein



YouTube