

# C40

Partition



Installation illustrate

Web : <https://www.mwworkstation.com/>

Tel : +86 13695211636

Mail : [robbor@mwworkstation.com](mailto:robbor@mwworkstation.com)

# C40

Partition



FAST AND CONVENIENT INSTALLATION SYSTEM  
DESK SYSTEM SCREEN SYSTEM

## PRODUCT

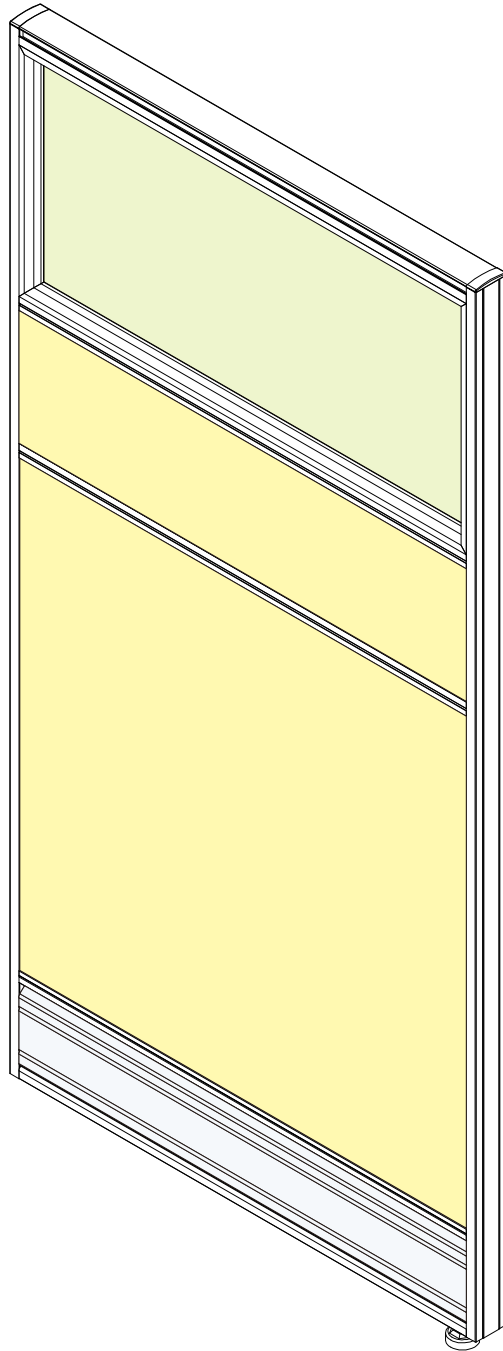

## Aluminum profiles parts

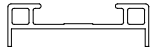

A pole  
7234#



Side cover  
7242#



Top cover  
7237#

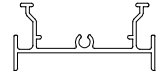

Top bar  
7236#

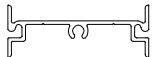

Mid bar A  
5965#

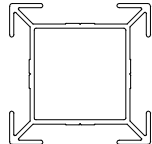

Corner pole  
7235#



Single glass groove  
7349#



Double glass groove  
7350#

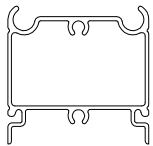

Big mid bar  
7321#

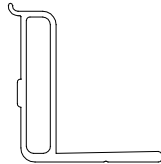

C32.DMFGHGLJJ.01  
7319#

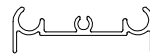

Cable bar(down)  
7238#



Cable hook stabilizer  
7247#

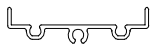

Cable bar  
7239#

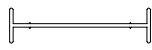

Mid bar B  
5967#

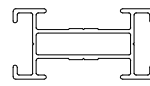

C40&C20 corner pole  
7314#



C20 side cover  
7304#

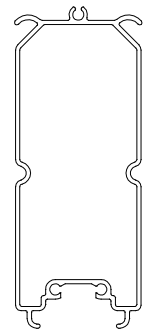

Cable hook  
7240#



All-purpose cable channel  
2431#



T3 cable channel  
3571#

## Accessories parts

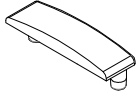

Top side cap

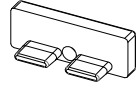

Top bar cap

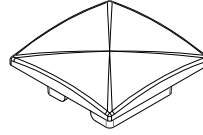

Corner pole cap

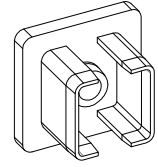

Corner pole foot

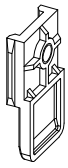

Panel connector  
(with M6\*8 screw)

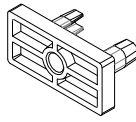

T3 cable connector

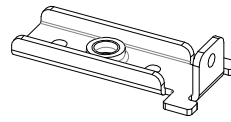

Single foot

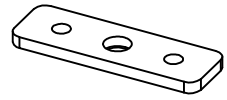

All use cable foot

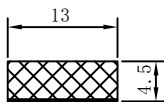

EVA rubber  
(13\*4.5mm)



T3 glass rubber  
U9-4

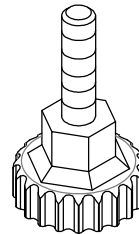

Hk32 adjustor

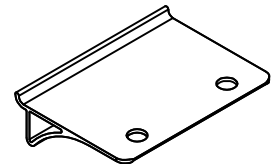

Xd318 Aluminum bracket



C20 corner pole  
panel connector  
(with M6\*8 screw)

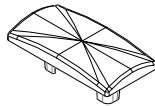

C40&C20 cap

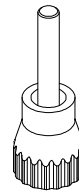

C20 adjustor

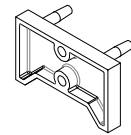

Cable bar(up) stabilizer

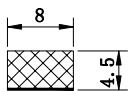

EVA rubber  
(8\*4.5mm)

## General design character

### I.C40 details:

1.Aluminum frame, block system partition

2.C40 thickness:40mm

### II.End trim:

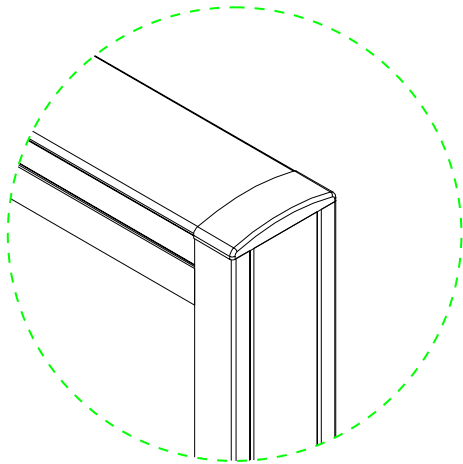

### III.Corner connections:

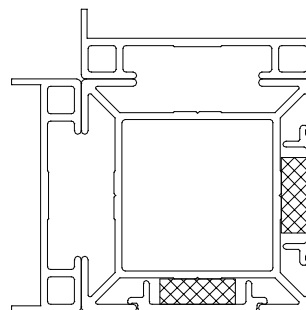
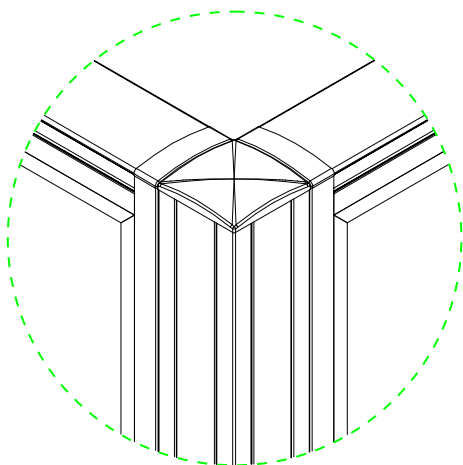

## Structure

### I.C40 structure details:

- 1.Panel-base system, aluminum frame includes powder coated and anodized.
- 2.Block material:(4mm)glass/polycarbonat, melamine, fabric, metal sheet, white board and accessories rail.

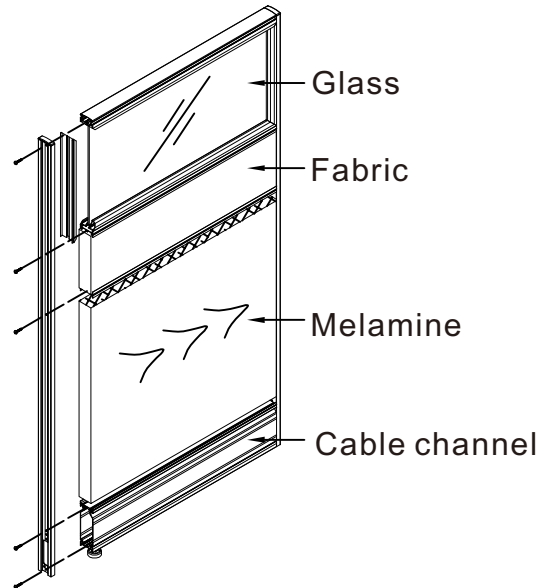
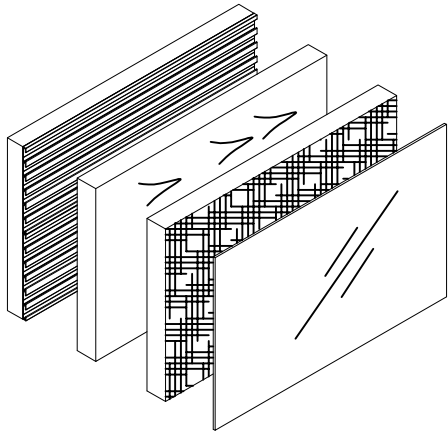

### 3.C40 cable channel (wire):two options.

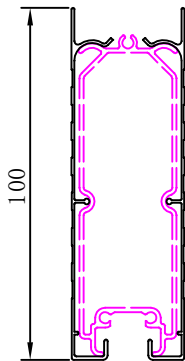

All-purpose cable channel

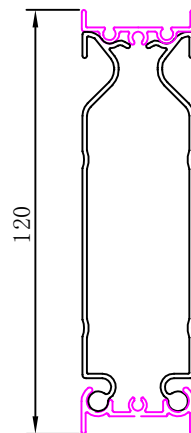

T3 cable channel

## Structure

### II. Capacity of cable channel

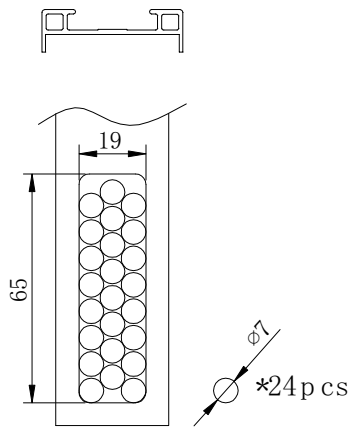

All-puepose cable channel & T3-120 cable channel

### III. C40 Panel explosion details

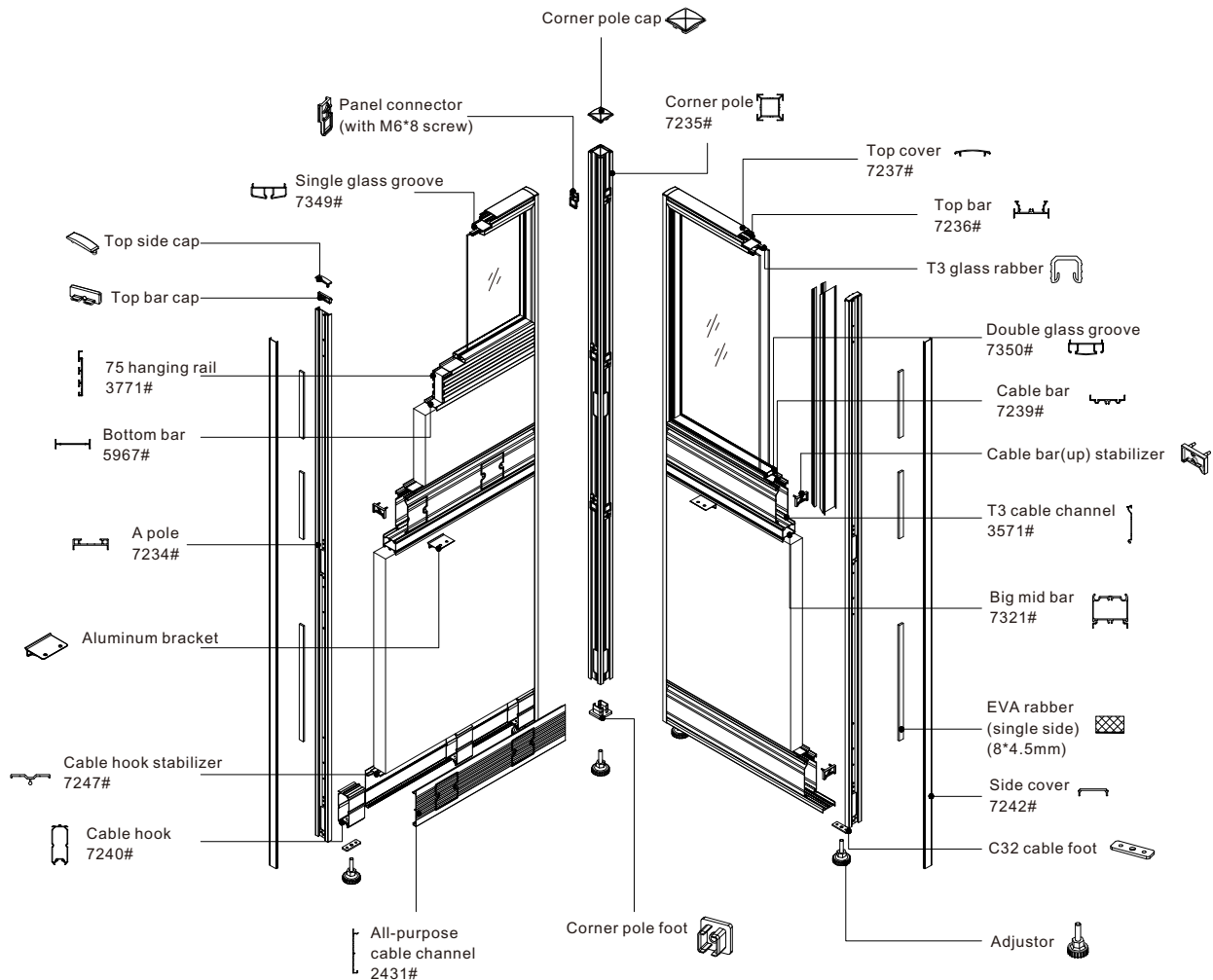

## Connections

I. Between panels and poles:

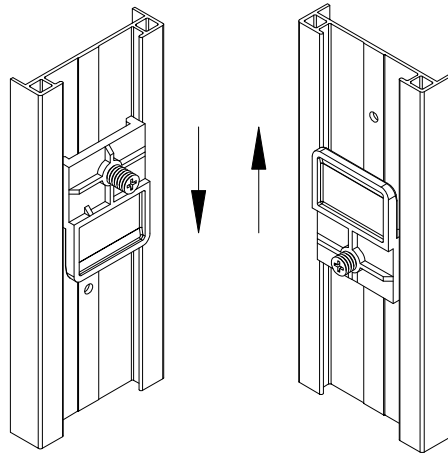

Fastening

II. Different thickness connections (take L connections for example):

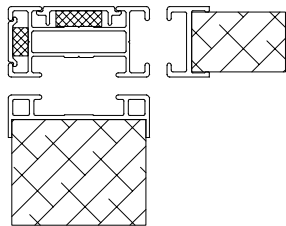

C20&C40

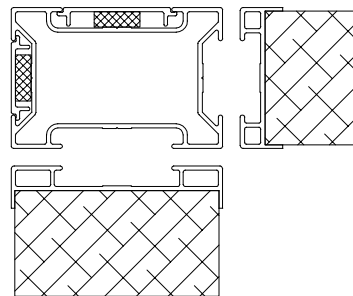

C40&C60



## Supporting system

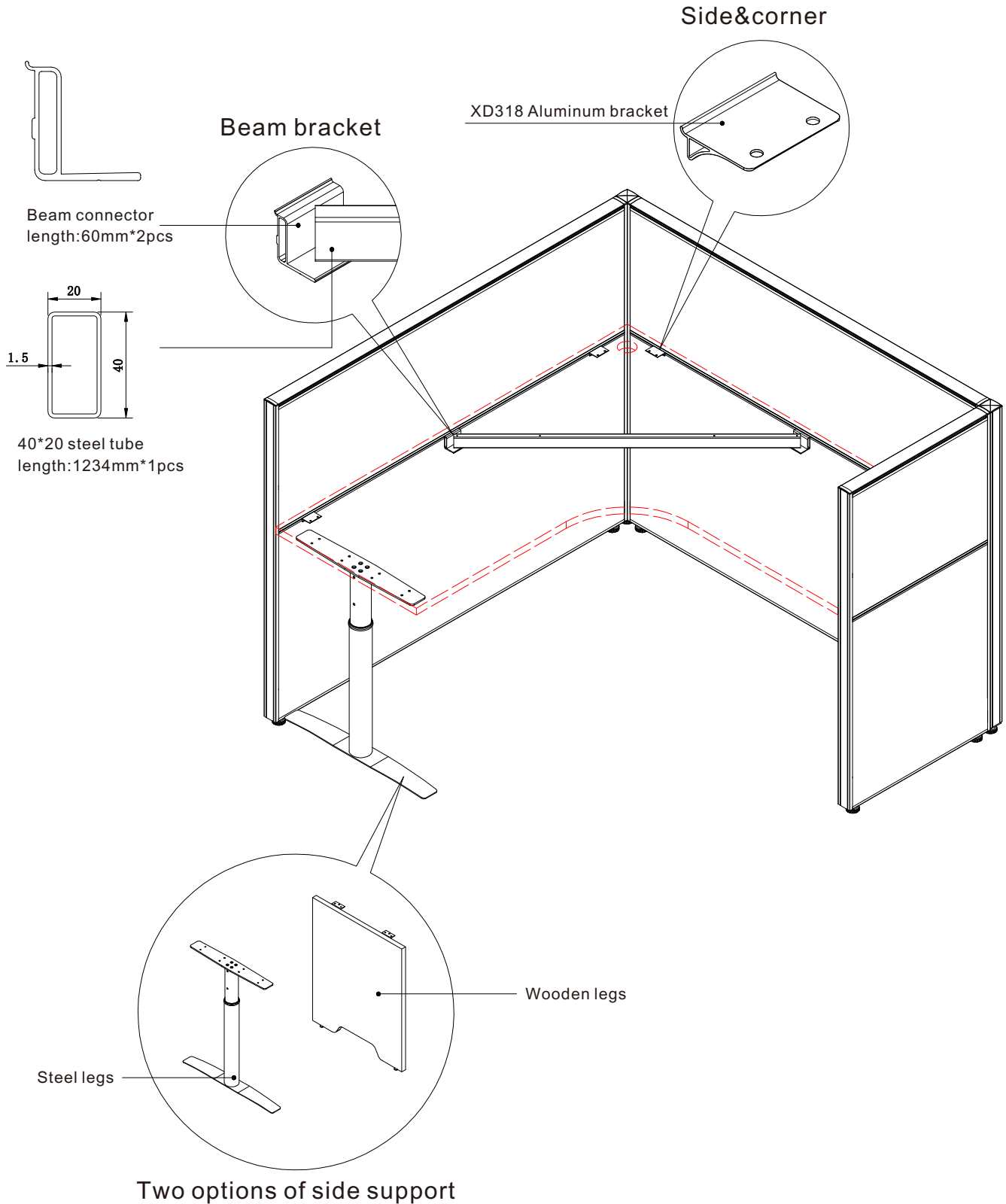

## Hangings system

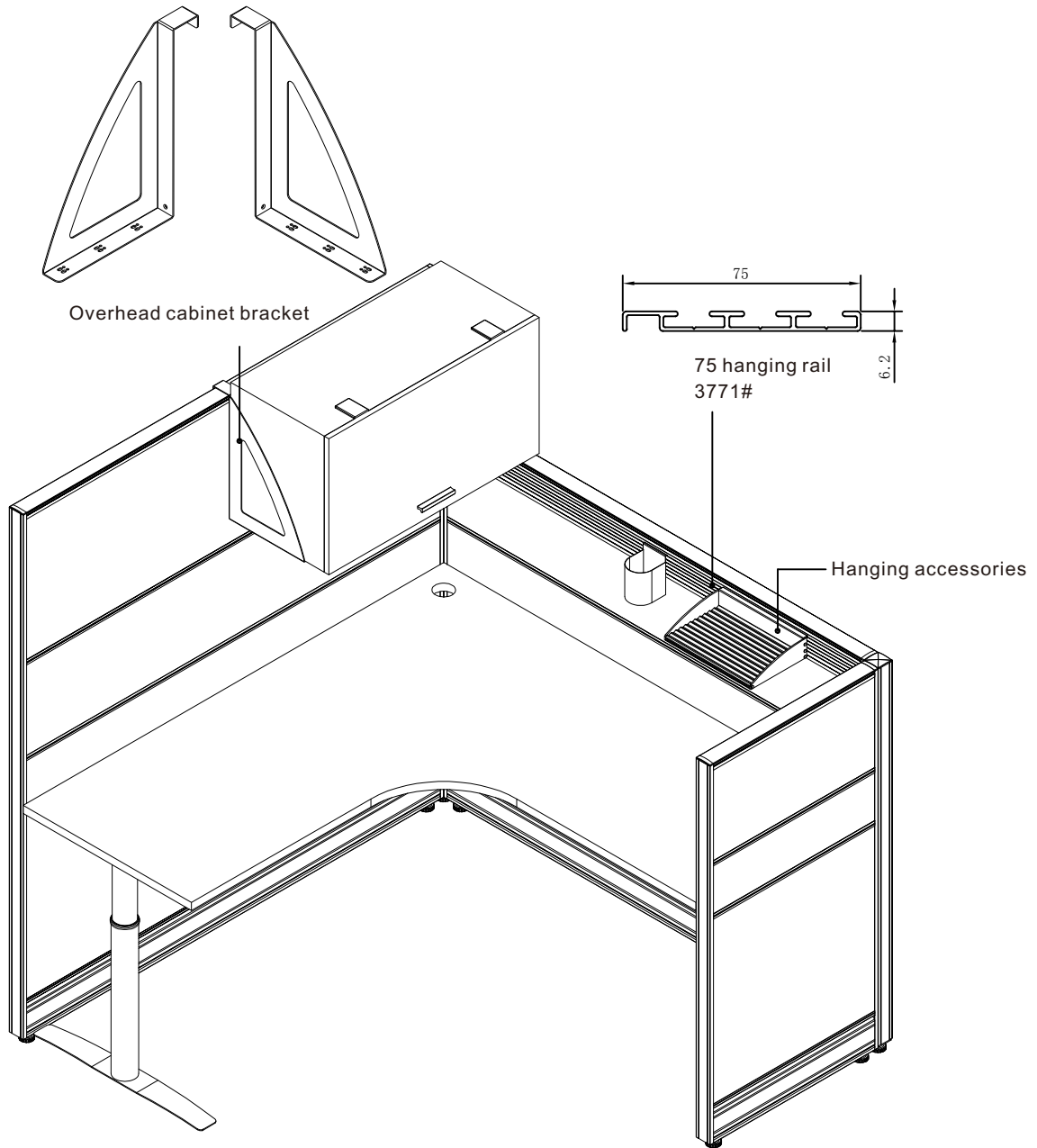

## Segments details

I. Without cable channel:

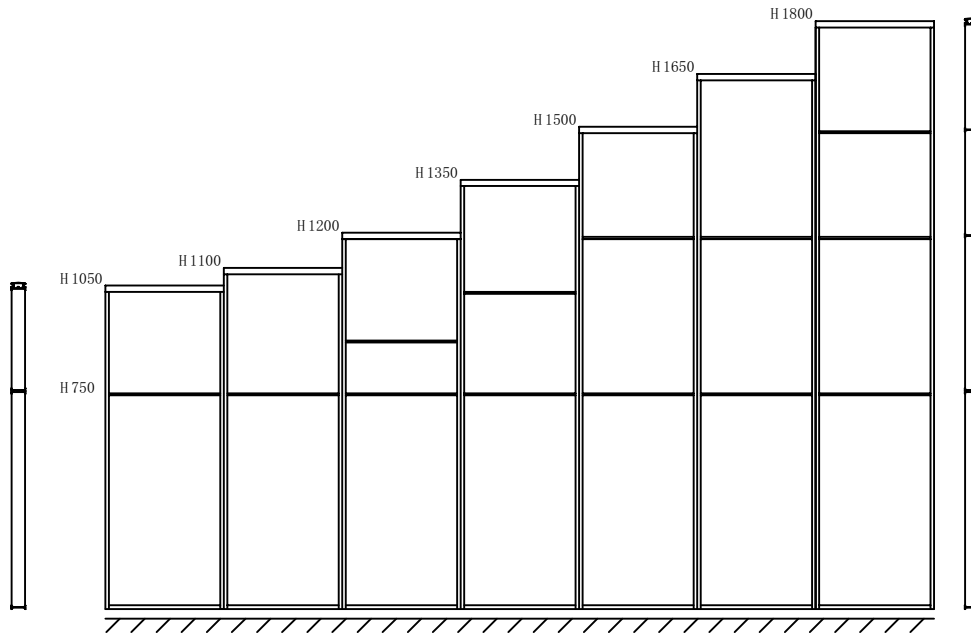

H: 1050/1100/1200/1350/1500/1650/1800 (mm).

W: 450/500/600/750/800/900/1050/1200/1400/1500/1600/1800 (mm).

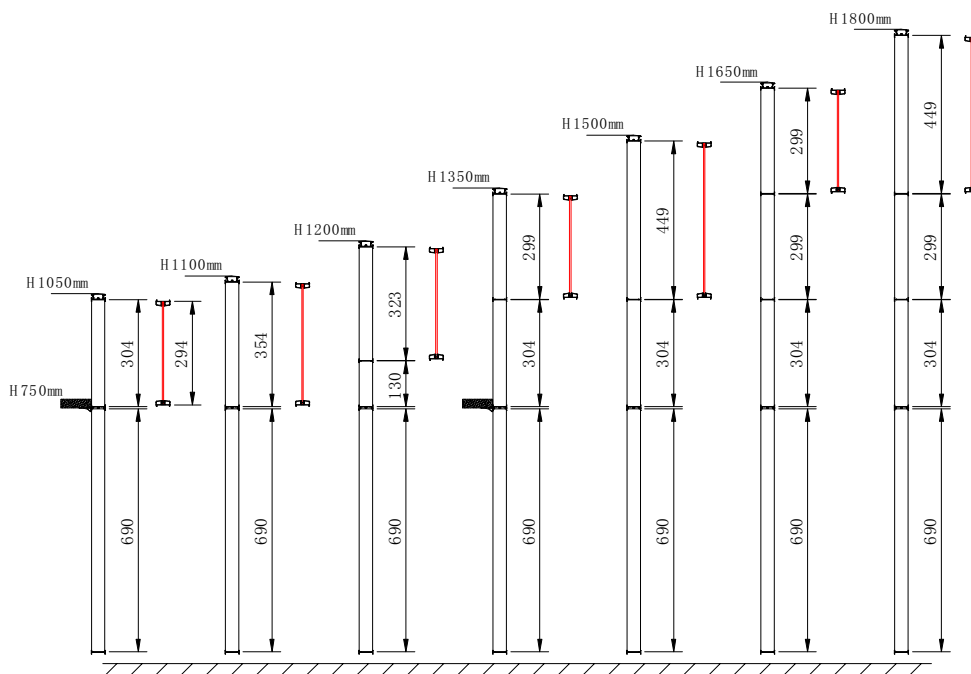

## II. All-purpose cable channel on bottom:

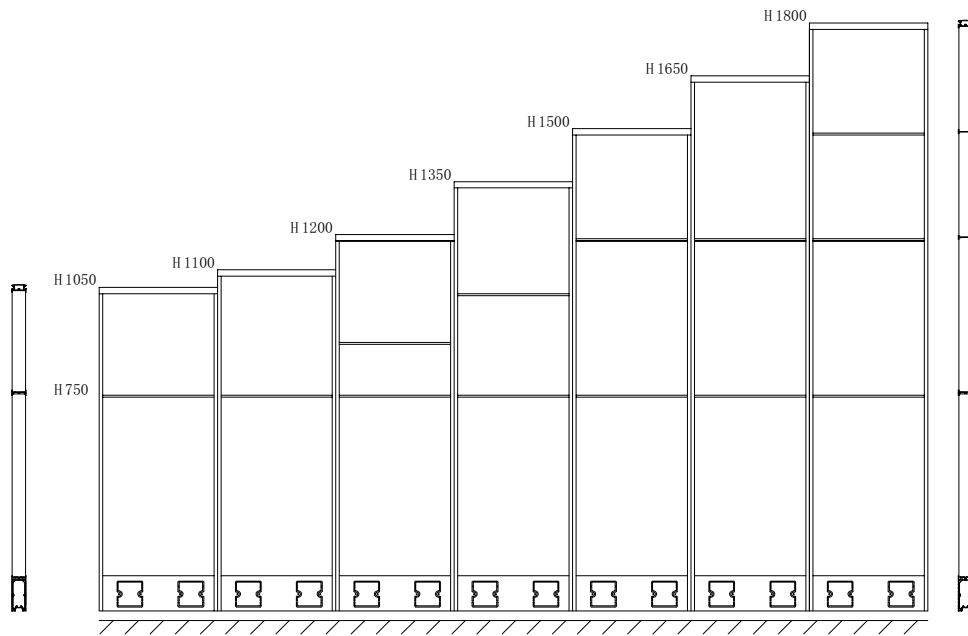

H: 1050/1100/1200/1350/1500/1650/1800 (mm).

W: 450/500/600/750/800/900/1050/1200/1400/1500/1600/1800 (mm).

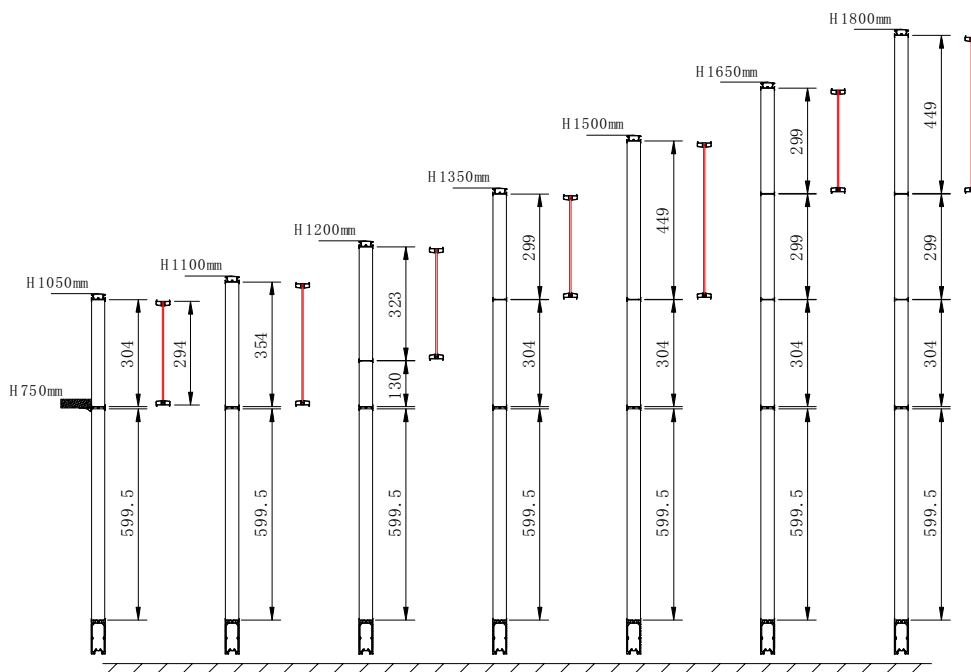

## III. T3 cable channel on bottom:

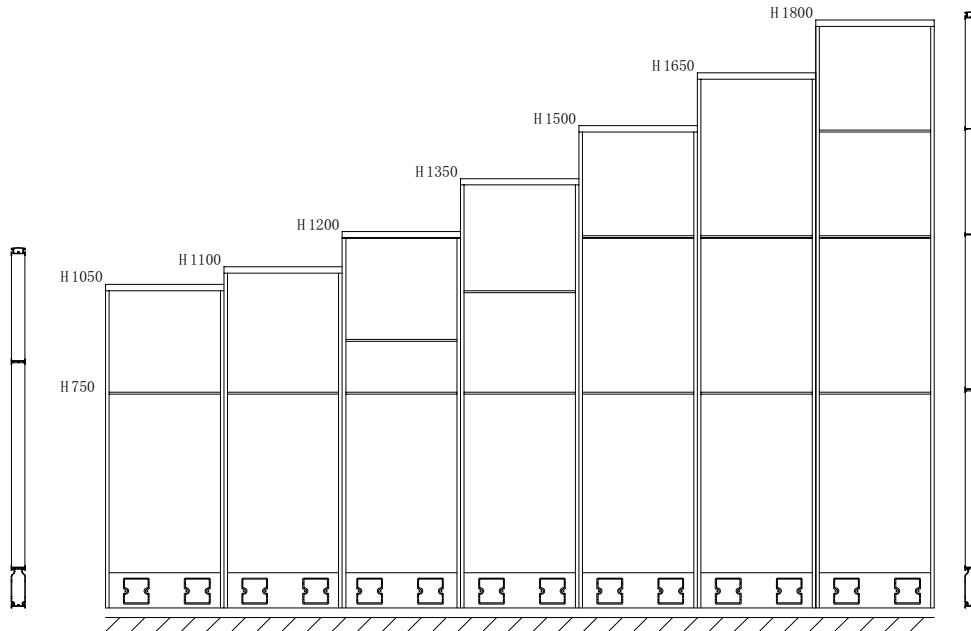

H: 1050/1100/1200/1350/1500/1650/1800 (mm).

W: 450/500/600/750/800/900/1050/1200/1400/1500/1600/1800 (mm).

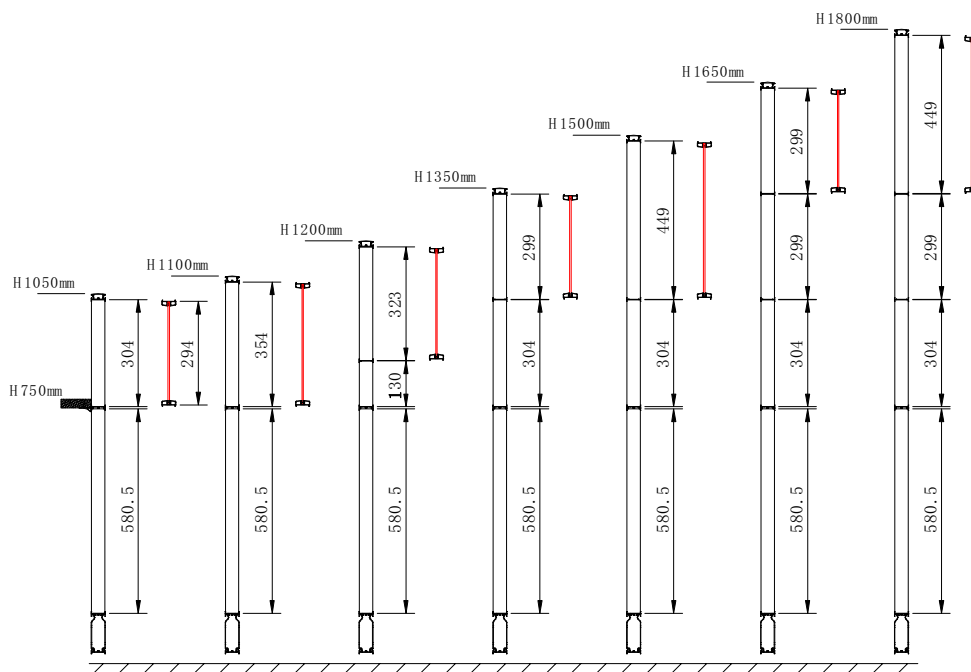

## IV. Double T3 cable channel:

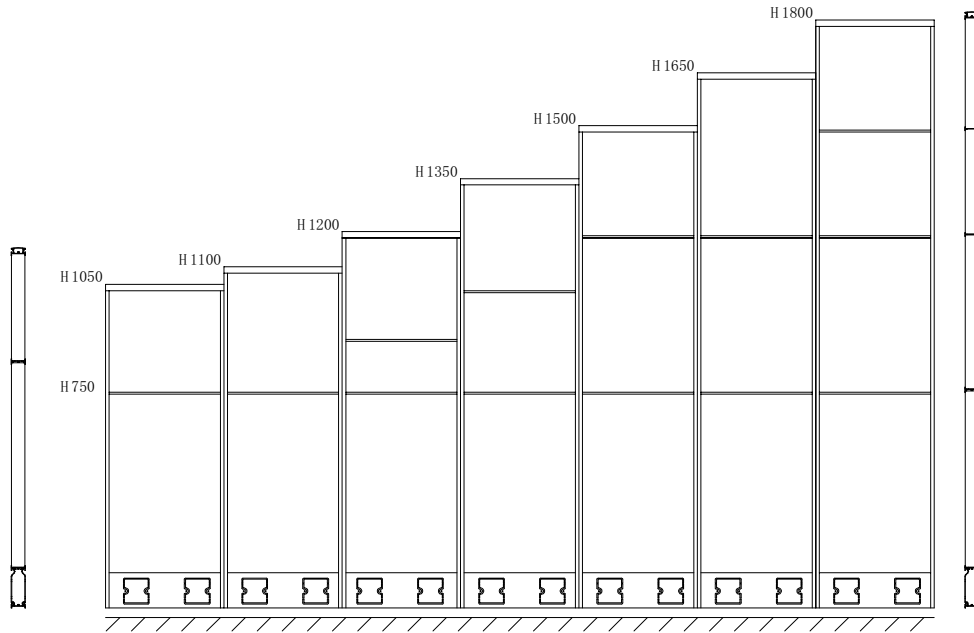

H: 1050/1100/1200/1350/1500/1650/1800 (mm).

W: 450/500/600/750/800/900/1050/1200/1400/1500/1600/1800 (mm).

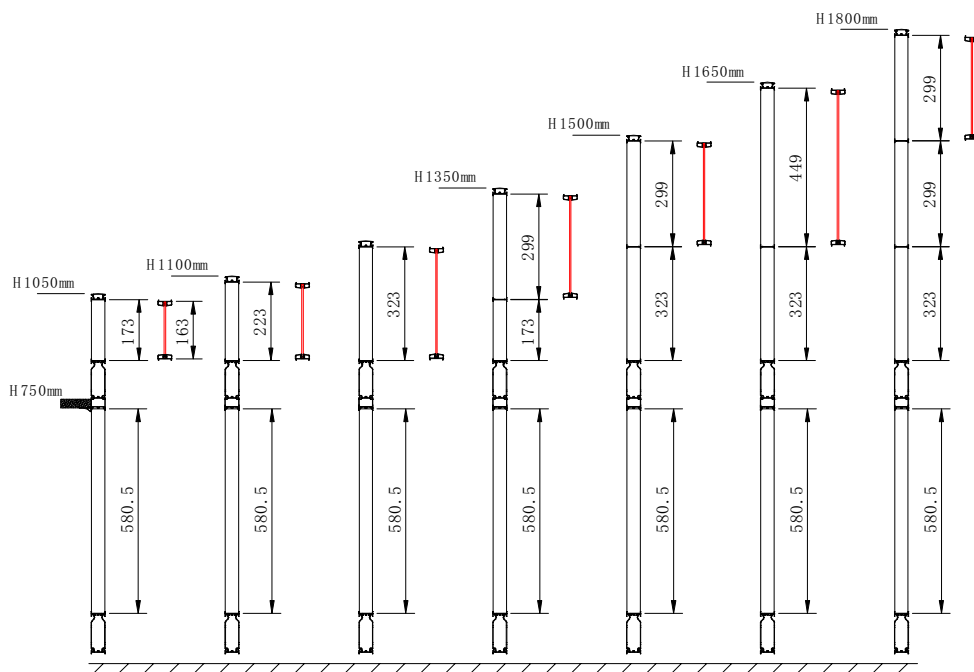

V.T3 cable channel in the mid and All-purpose cable channel on the bottom:

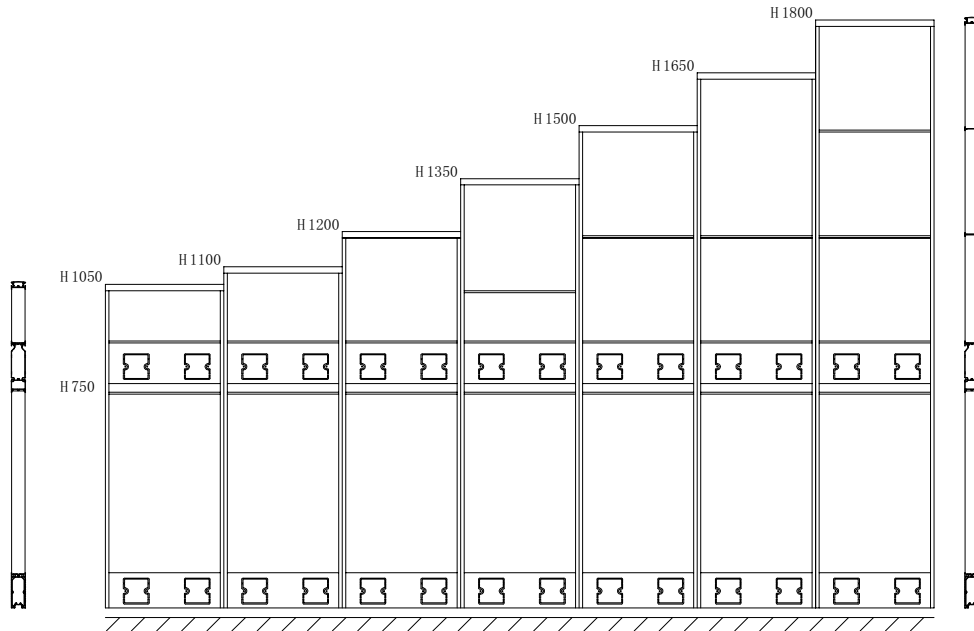

H: 1050/1100/1200/1350/1500/1650/1800 (mm).

W: 450/500/600/750/800/900/1050/1200/1400/1500/1600/1800 (mm).

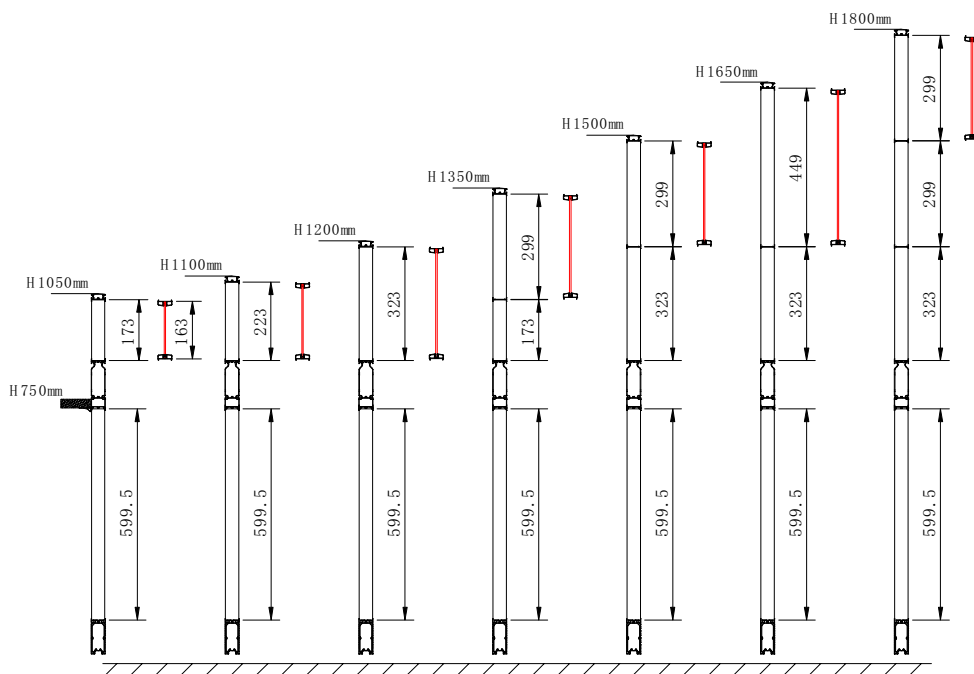

## Cut length logics

I. Formula:

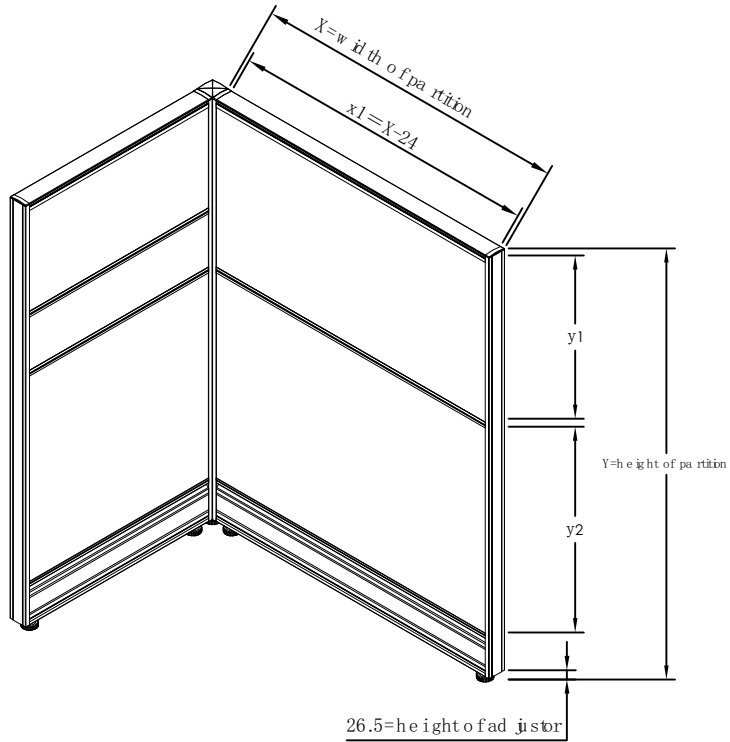

Unit:mm

Name	Code	Size	Diagram
top cover	C 40.DFB.01	X-24	
top bar	C 40.DG .01	X-24	
mid barA	C 40.FGZG .01	X-24	
bottom bar	HK40.XG .01	X-24	
cab le bar (up)	C 40.XC SG .01	X-24	
cab le bar (down)	C 40.XC XG .01	X-24	
cab le hook holder	C 32.TYXC JG T.01	X-44	
big mid bar	C 40.DXC ZG.01	X-24	
cab le channel	320.XC B.01	X-24	
T3 cable channel	T3.XC B.01	X-25	

Name	Code	Size	Diagram
A pole	C 40.AZ .01	Y-31	
side cover	C 32.CF B.01	Y-31	
comer pole	C 40.FZ.01	Y-31	
40 & 20 comer pole	C 40.40+20LJZ.01	Y-26	
double glass groove	C 40.XD BLC.01	y1-10	
double glass groove	C 40.XD BLC .01	X-24	
75 hanging rail	C 32.75G C B.01	X-15	



## Cut length logics

### II. Material details:

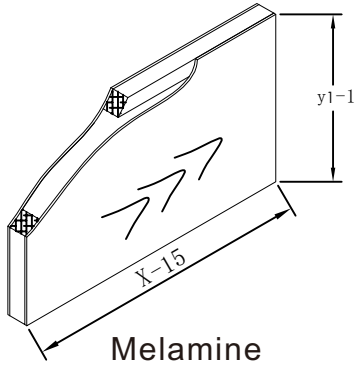

Melamine

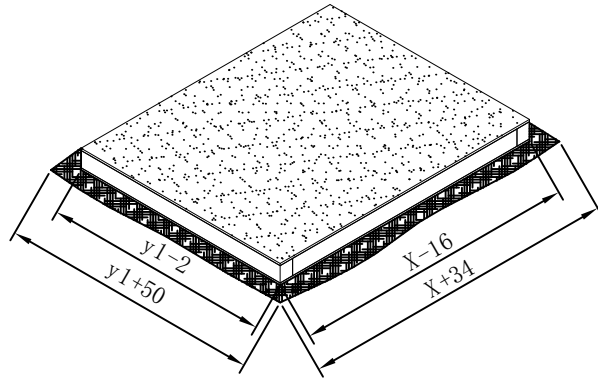

Board with fabric

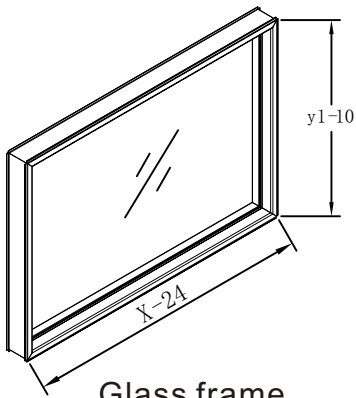

Glass frame

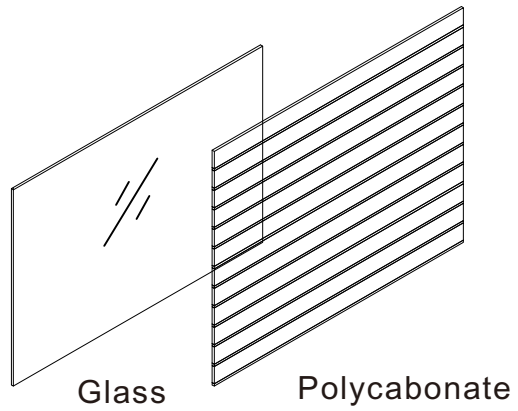

Glass

Polycarbonate

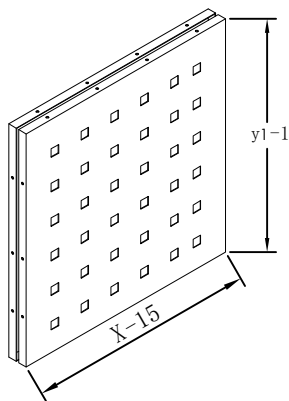

Metal block(except C20)

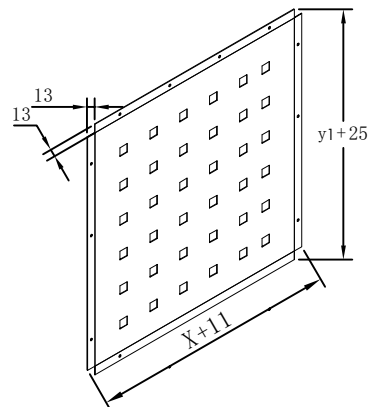

Metal sheet(before bent)

### III. Block thickness C40=38mm

## Holes punching

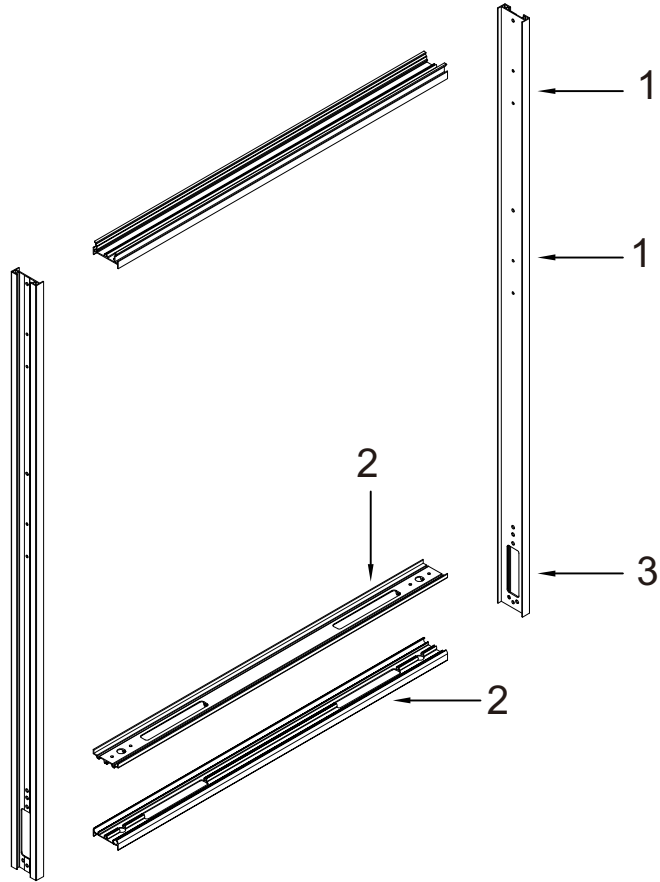

1. Mould for panel connected & top bar on A pole

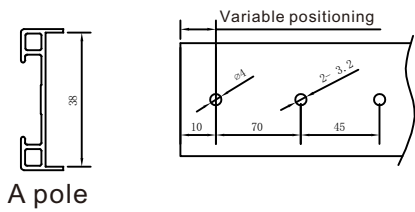

A pole

2. Mould for wire & adjustor holes on cable bar (down)

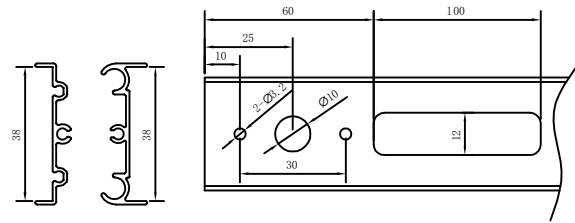

Cable bar up and down

3. Mould for wire to T3 cable channel holes on A pole

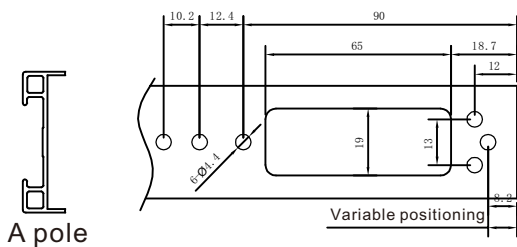

A pole

# M & W

**Web:** [mwworkstation.com](http://mwworkstation.com)

**Mail:** [robbor@mwworkstation.com](mailto:robbor@mwworkstation.com)

**Tel:** +86 13695211636

**WhatsApp:** + 86 13695211636

**Add:** NO.3 Xingye North Road Dawotang Industrial  
District Shishan Nanhai Foshan City Guangdong  
P.R China



WhatsApp



Facebook



Instagram



Twitter



Pinterest



Linkein



YouTube