

# T8

Partition



Installation illustrate

Web : <https://www.mwworkstation.com/>

Tel : +86 13695211636

Mail : [robbor@mwworkstation.com](mailto:robbor@mwworkstation.com)

# T8

## Partition



FAST AND CONVENIENT INSTALLATION SYSTEM  
DESK SYSTEM SCREEN SYSTEM

### PRODUCT

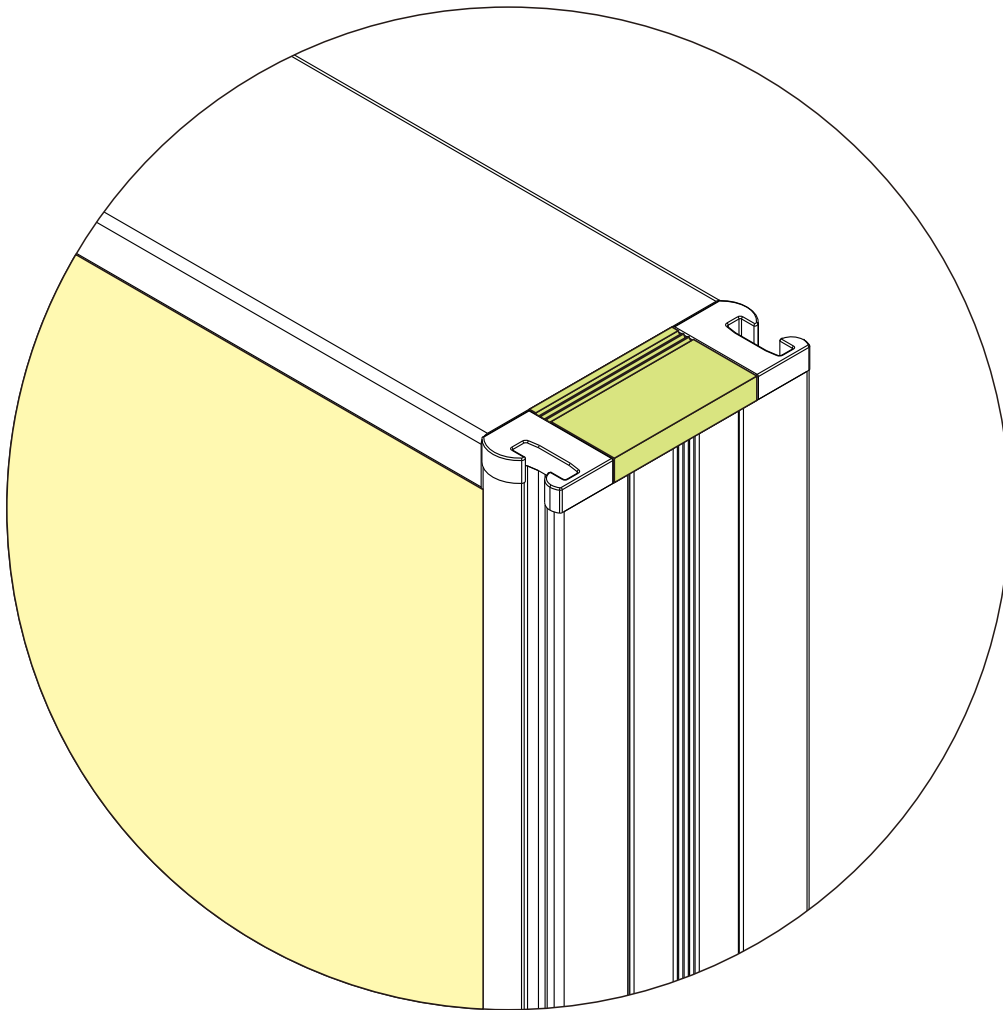

## Aluminum profiles parts



A pole  
3480#

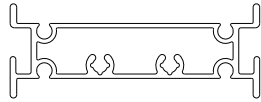

Mid bar  
3479#

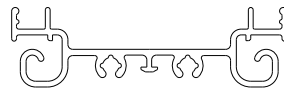

Top bar with acc groove  
3178#

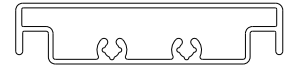

Top bar  
3147#

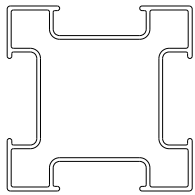

Square pole  
3146#

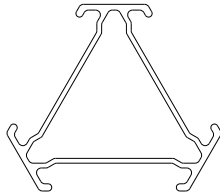

120° 3 ways  
connection pole  
3175#

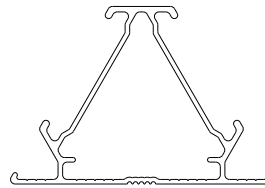

120° 2 ways  
connection pole  
3467#

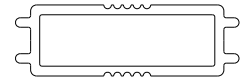

Side cover  
(PVC)

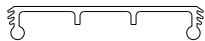

Glass strip  
(PVC)

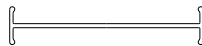

Bottom bar  
3526#

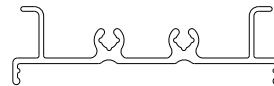

Cable bottom bar  
3186#



Cable cover  
3179#

## Accessories parts

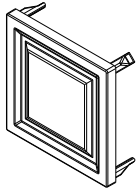

Square cap

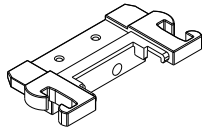

Side top cap

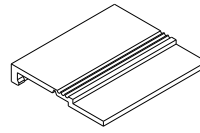

Plastic cap

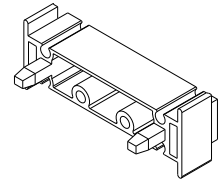

Middle bar cap

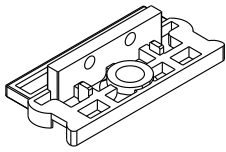

Single foot

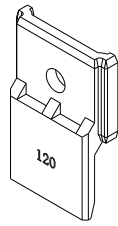

120 degrees  
panels connector

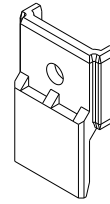

Panels connector

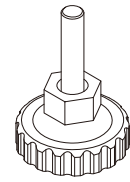

Adjustor

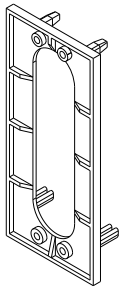

Cap channel connector

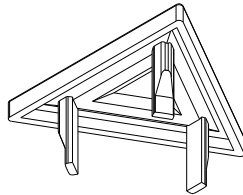

120° cap

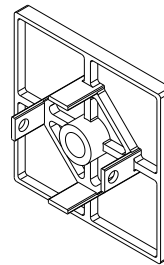

Aquare foot

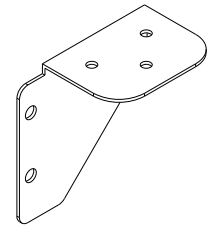

Small brackets

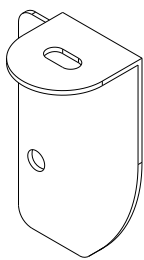

Small desktop brackets

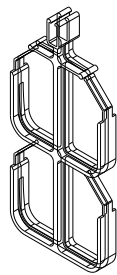

Cable hook

## General design character

### I.T8 details:

1.Aluminum frame, block system partition

2.T8 thickness:60mm

### II.End trim:

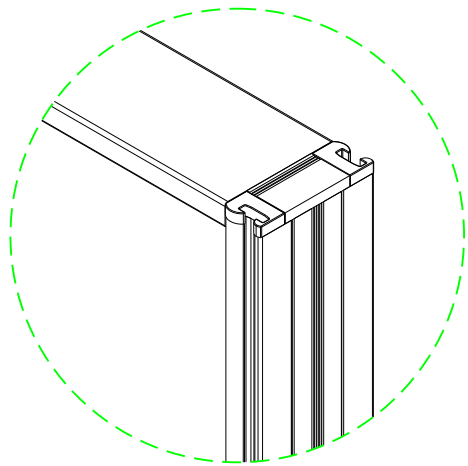

### III.Connections and trimming:

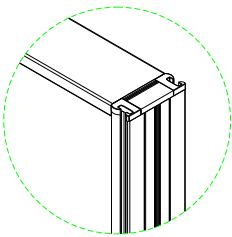

End trimming

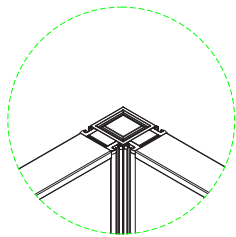

2 ways connection

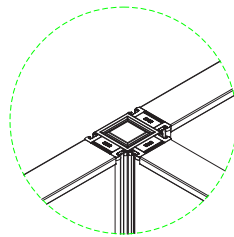

3 ways connection

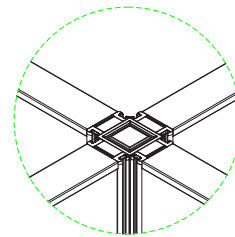

4 ways connection

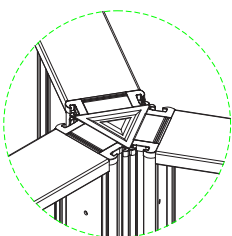

120° 3 ways connection

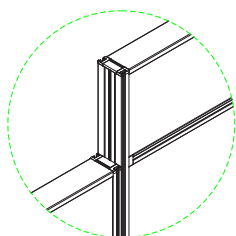

180° connection in different height

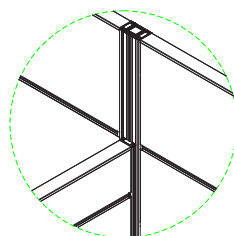

Three way connection in different height

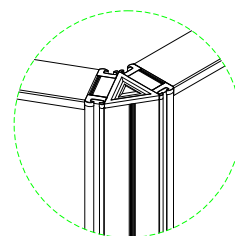

120° 2 ways connection

## Structure

### I.T8 structure details:

1. Panel-base system, aluminum frame includes powder coated and anodized.
2. Block material: (4mm) glass/polycarbonate, melamine, fabric, metal sheet, white board and accessories rail.

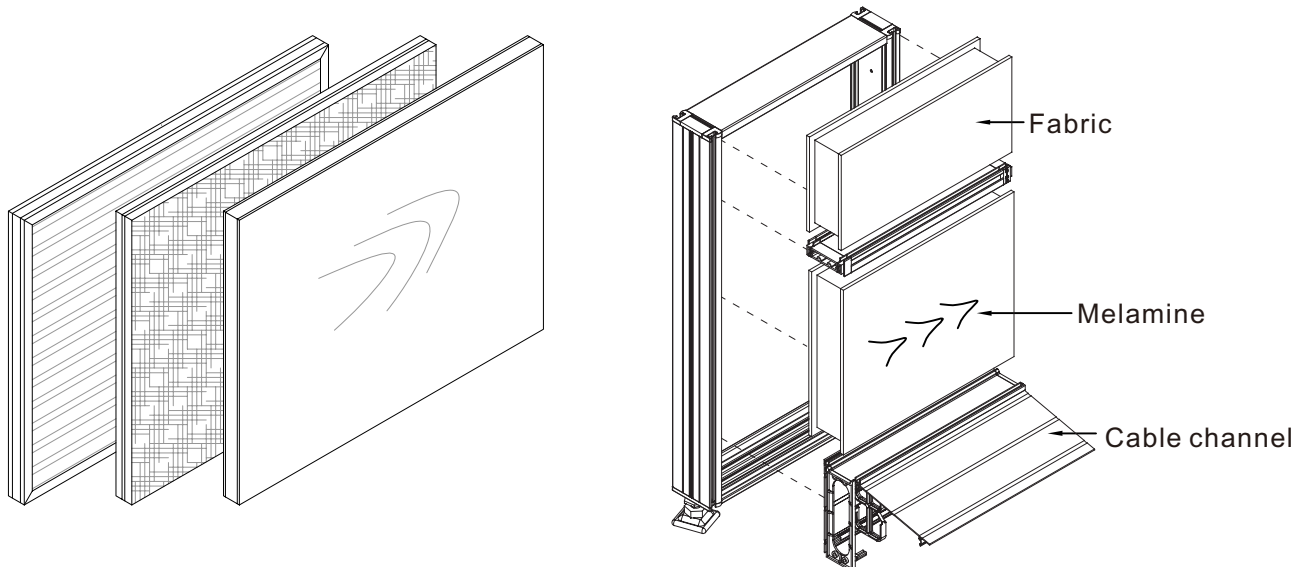

### 3.T8 cable channel (wire):

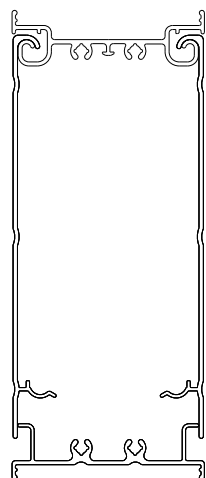

Cable channel

## Structure

### II. Partition assembling

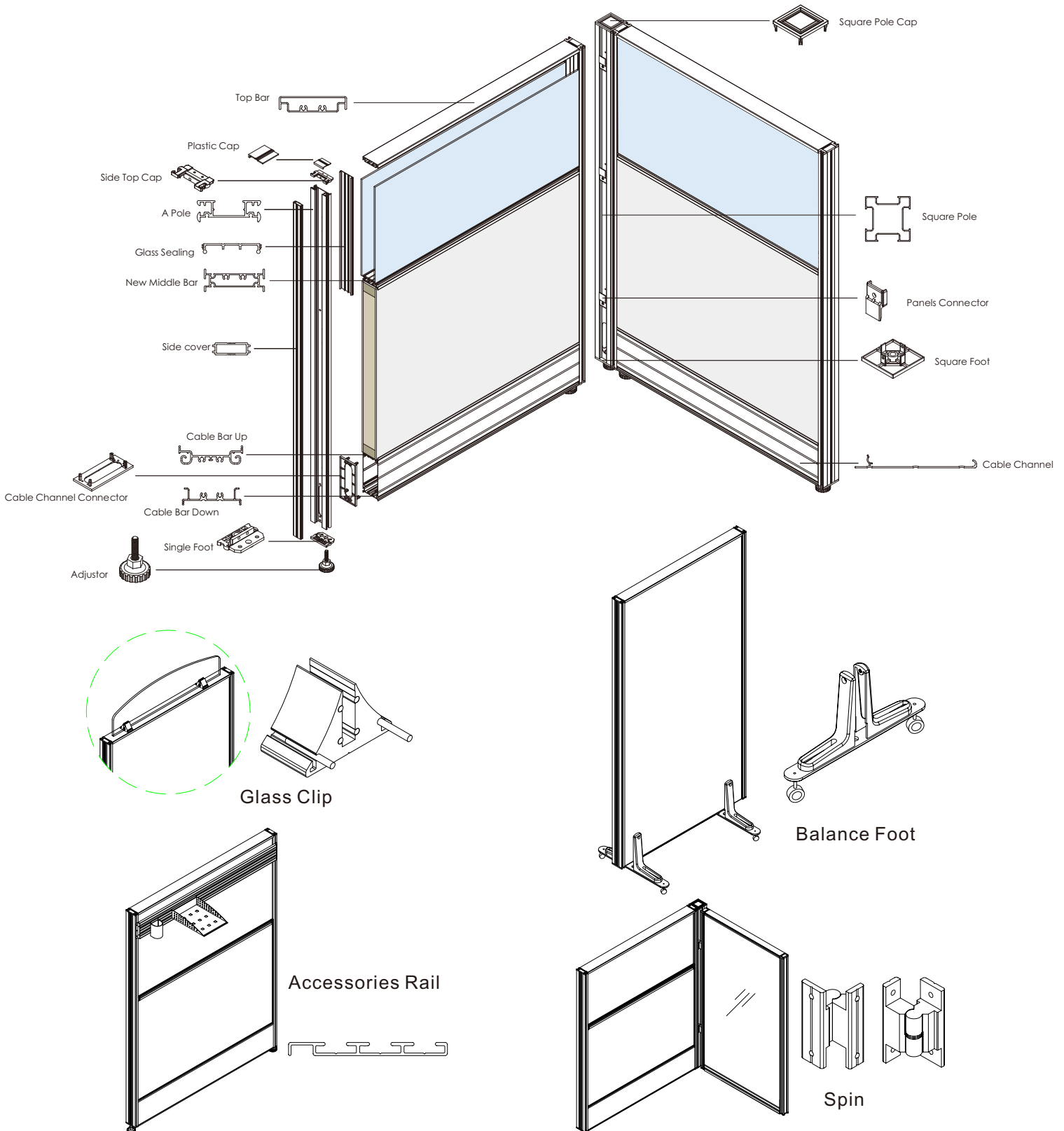

## Steps of assembling

I.

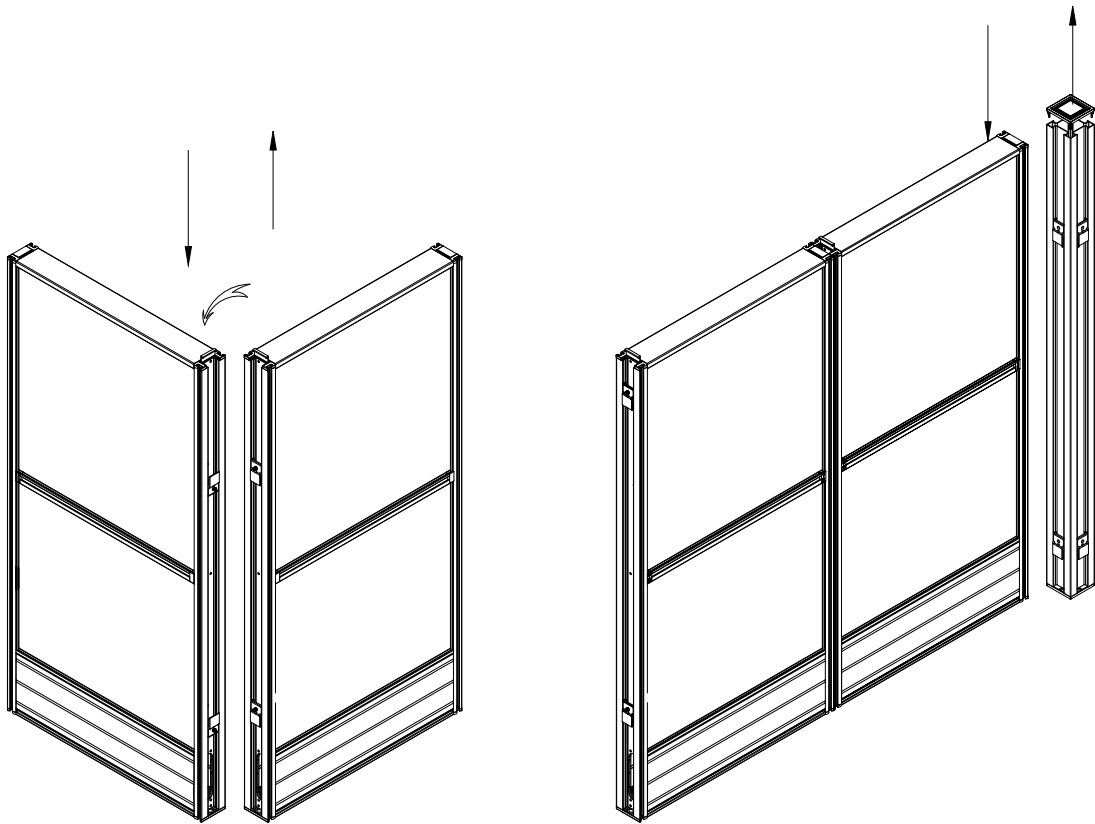

II.

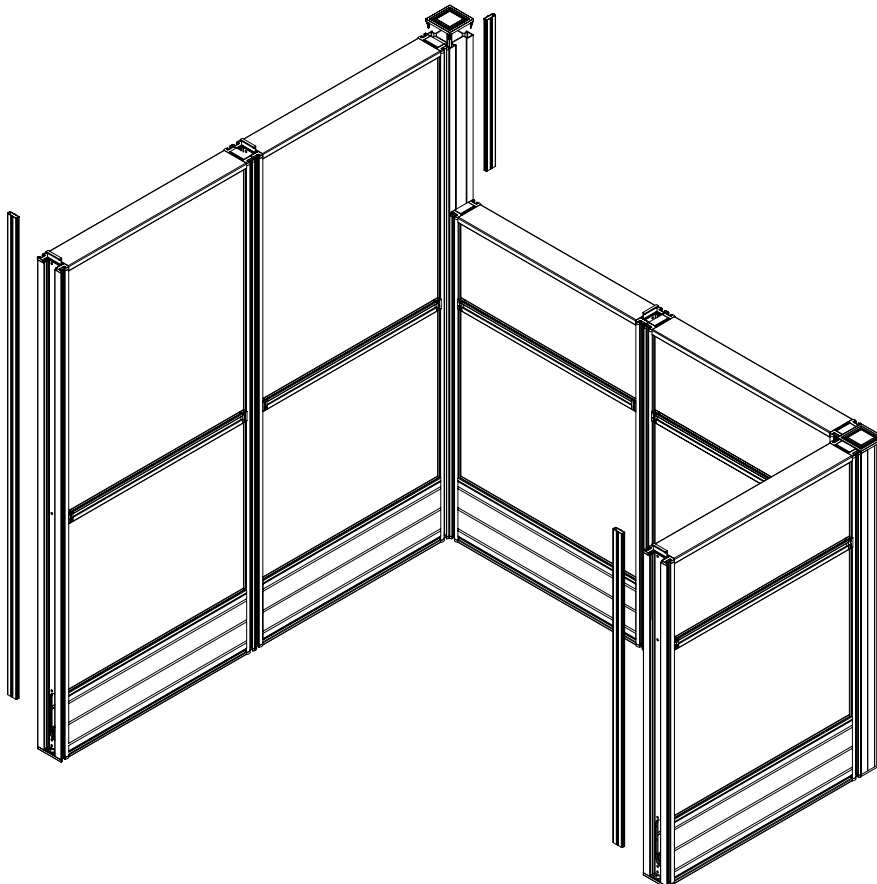



III.

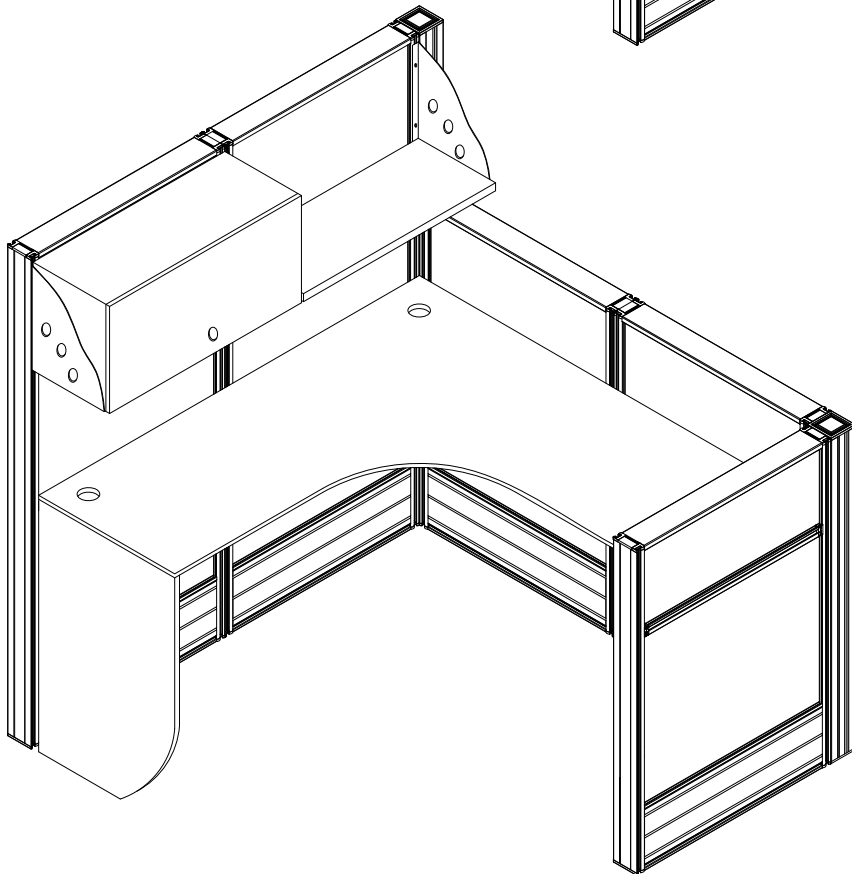
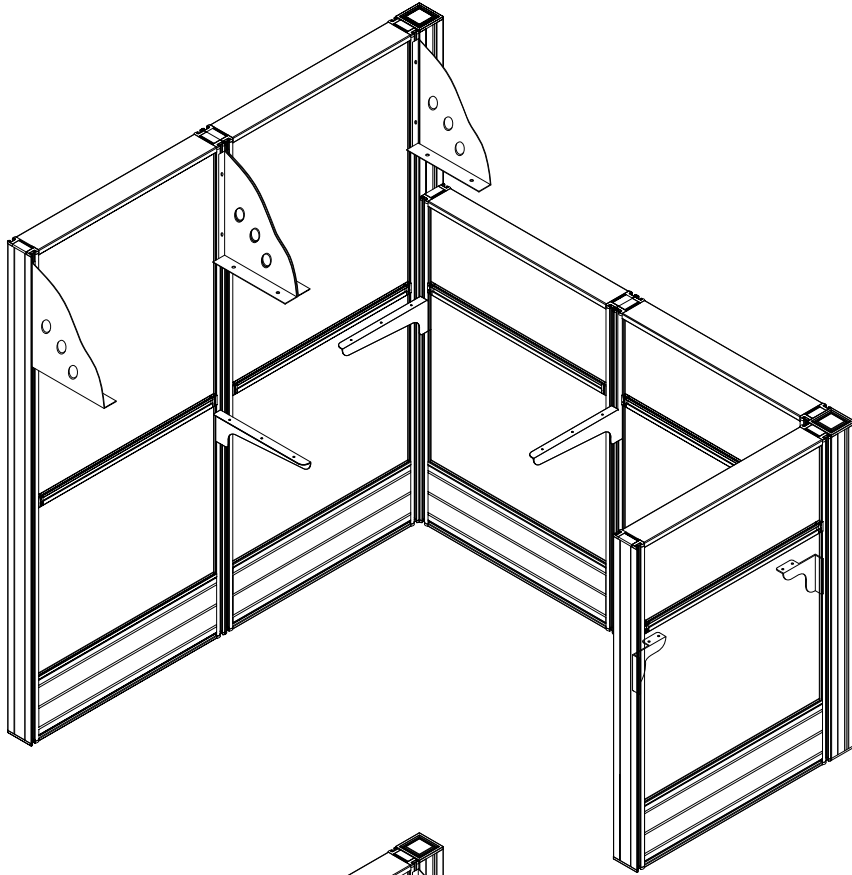

## Tiles instruction

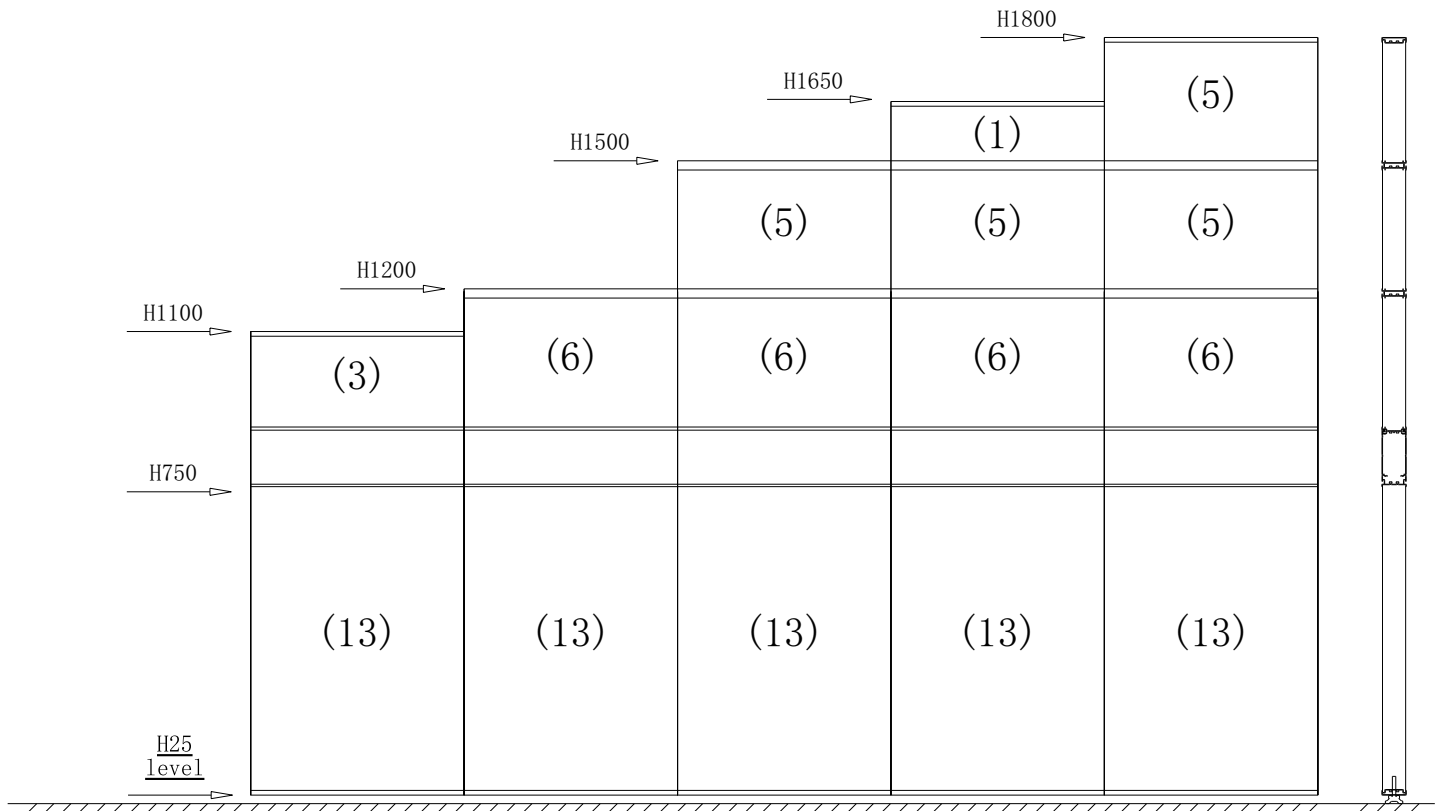
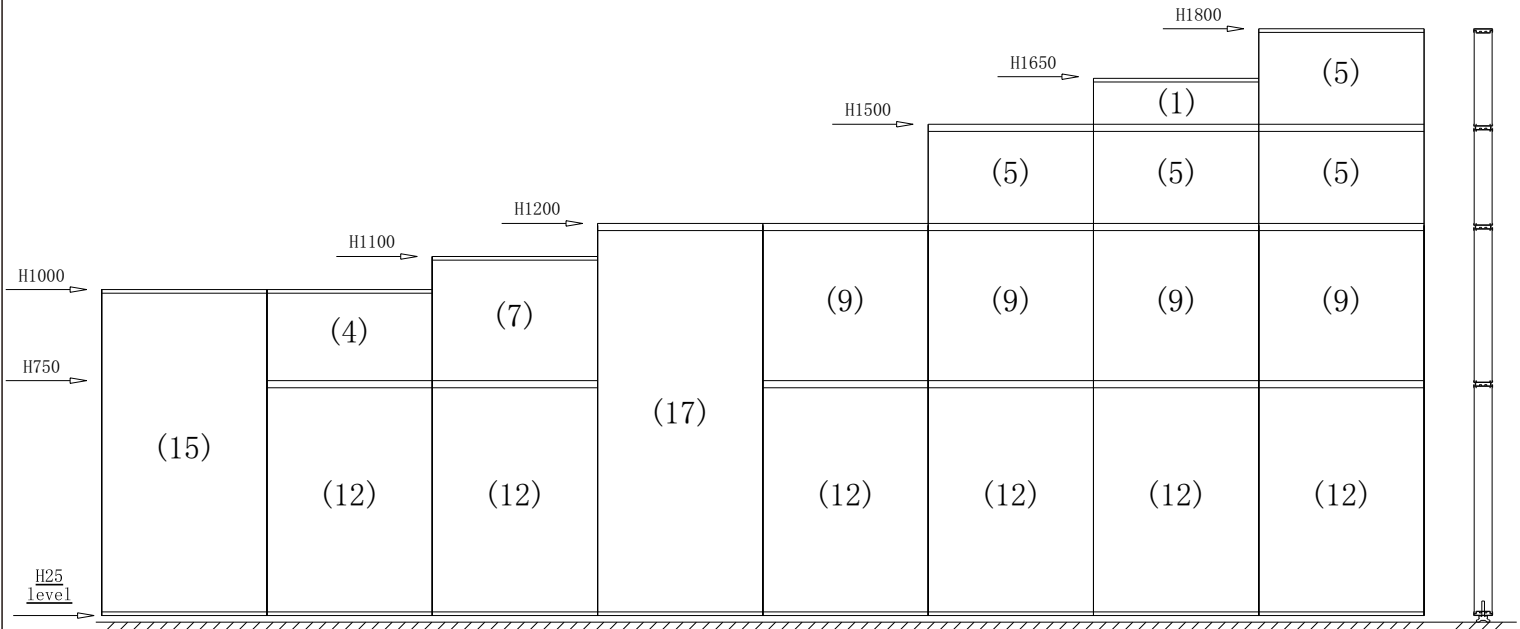

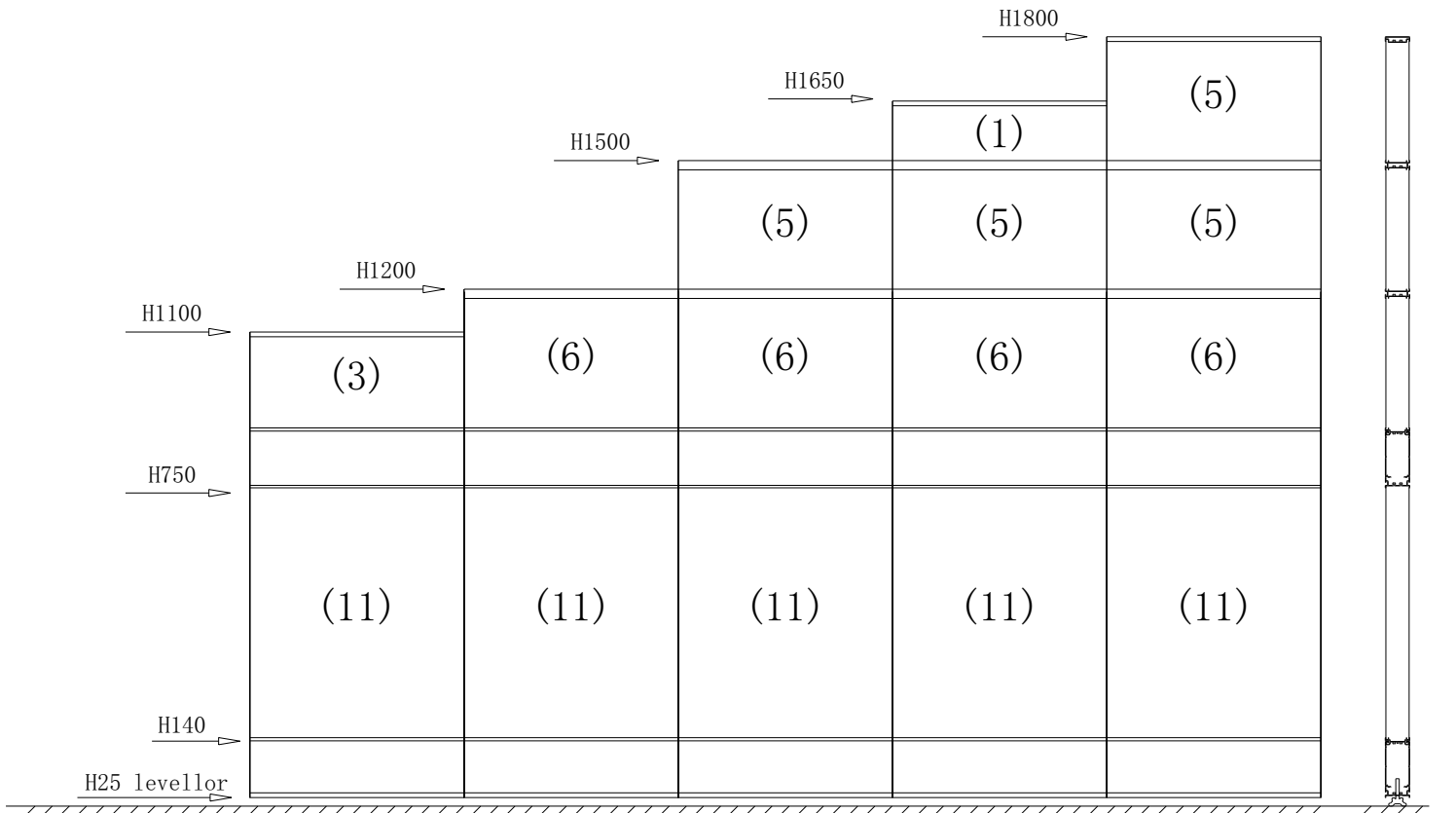
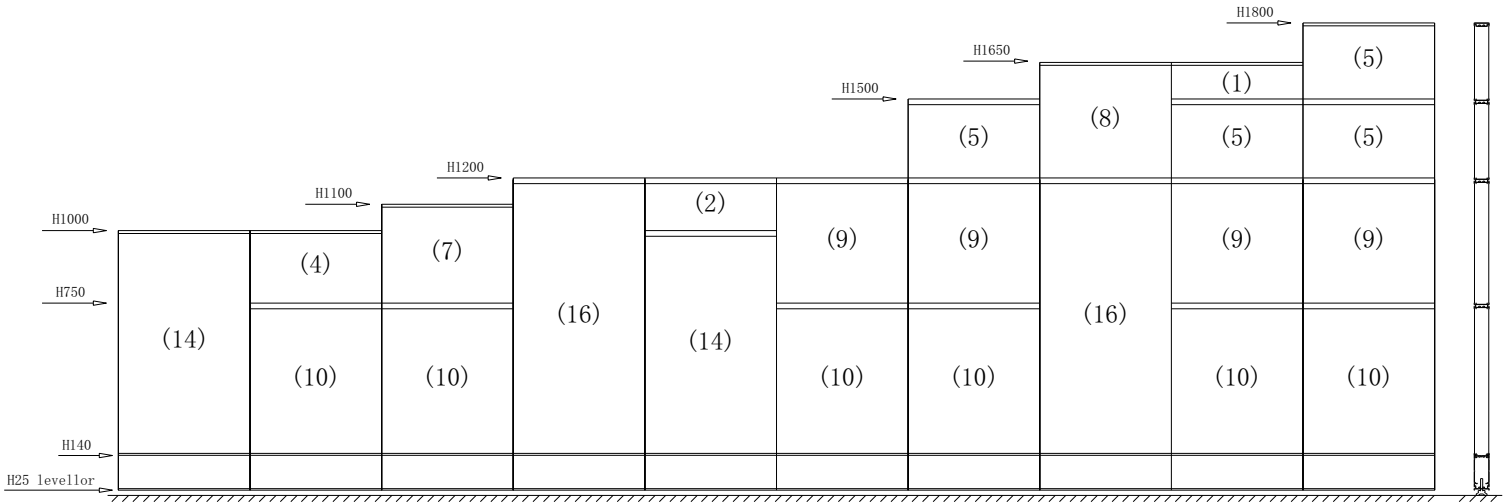

## Cut length logics

I. Formula:

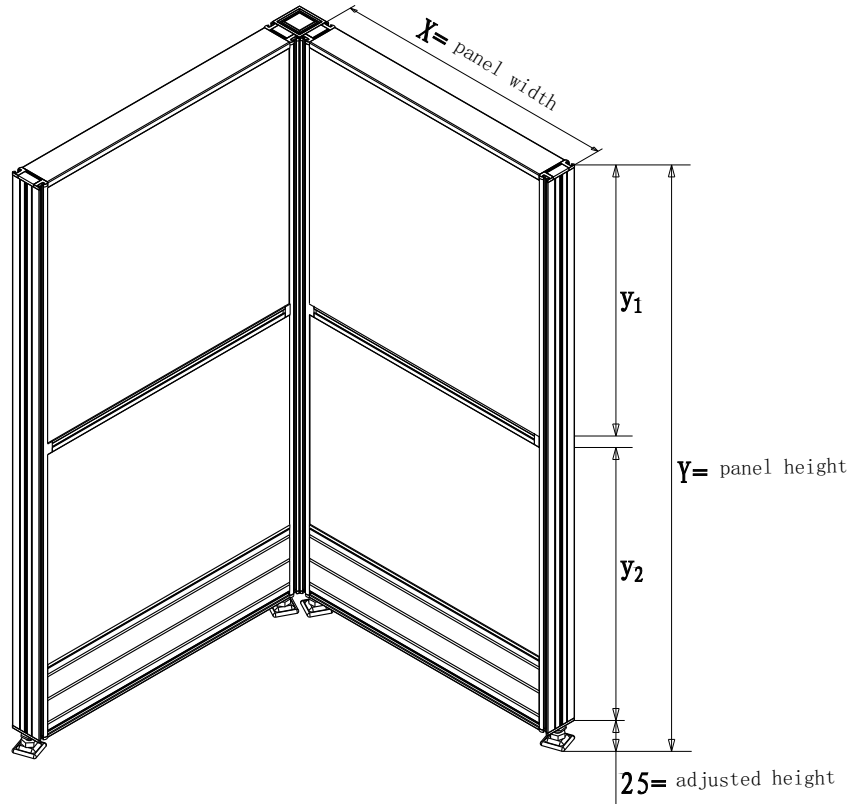

Unit:mm

item	code	spec	image	item	code	spec	image
Top Bar	T8-DG	X-40		Square Pole	T8-FZ	y-35	
Bottom Bar	T8-XG	X-40		Side Cover	T8-LJJT	y-35	
Mid Bar	T8-ZG	X-60		Glass Strip	T8-BLJT	X-32	
A Pole	T8-AZ	y-35		Glass Strip	T8-BLJT	y1-18	
Cable Top Bar	T8-XCSG	X-40					
Cable Bottom Bar	T8-XCDG	X-40					
Cable Channel	T8-XCB	X-40					

## Cut length logics

### II. Material details:

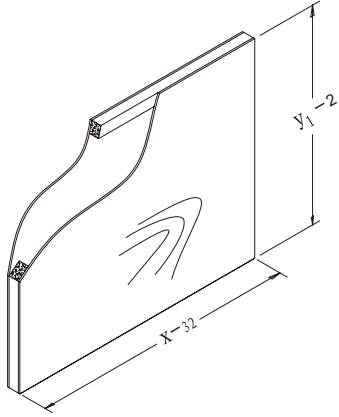

MFC block

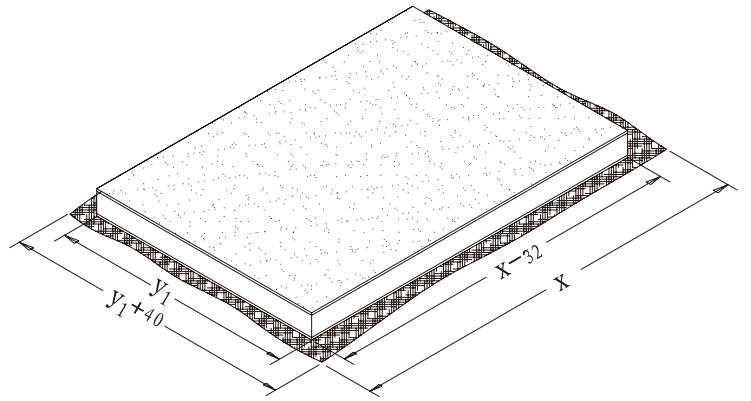

Fabric block

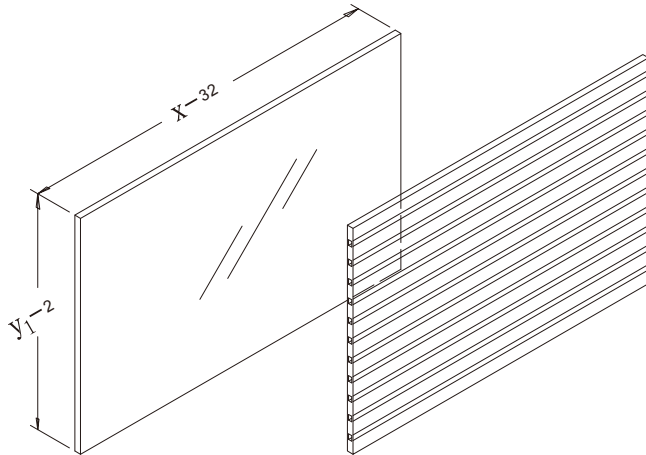

Glass/Polycarbonate

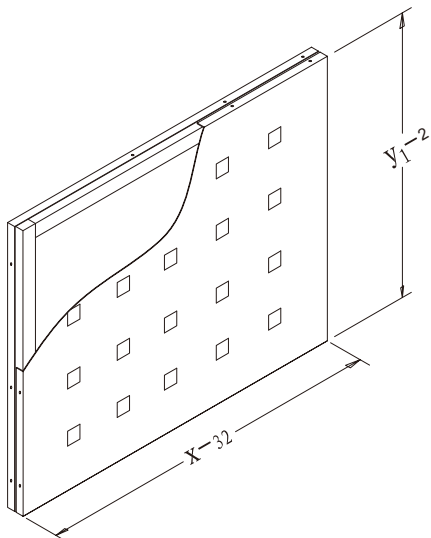

MS block

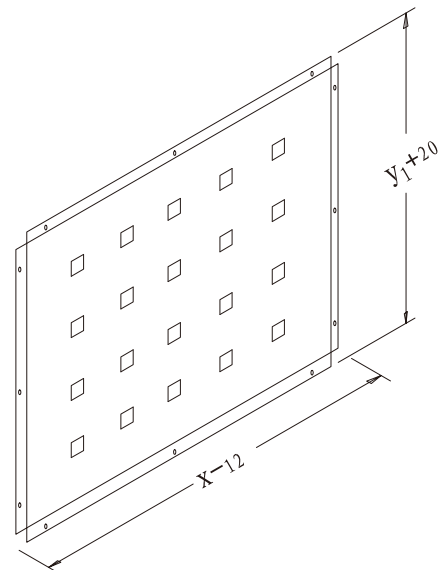

Metal sheet

# Holes punching

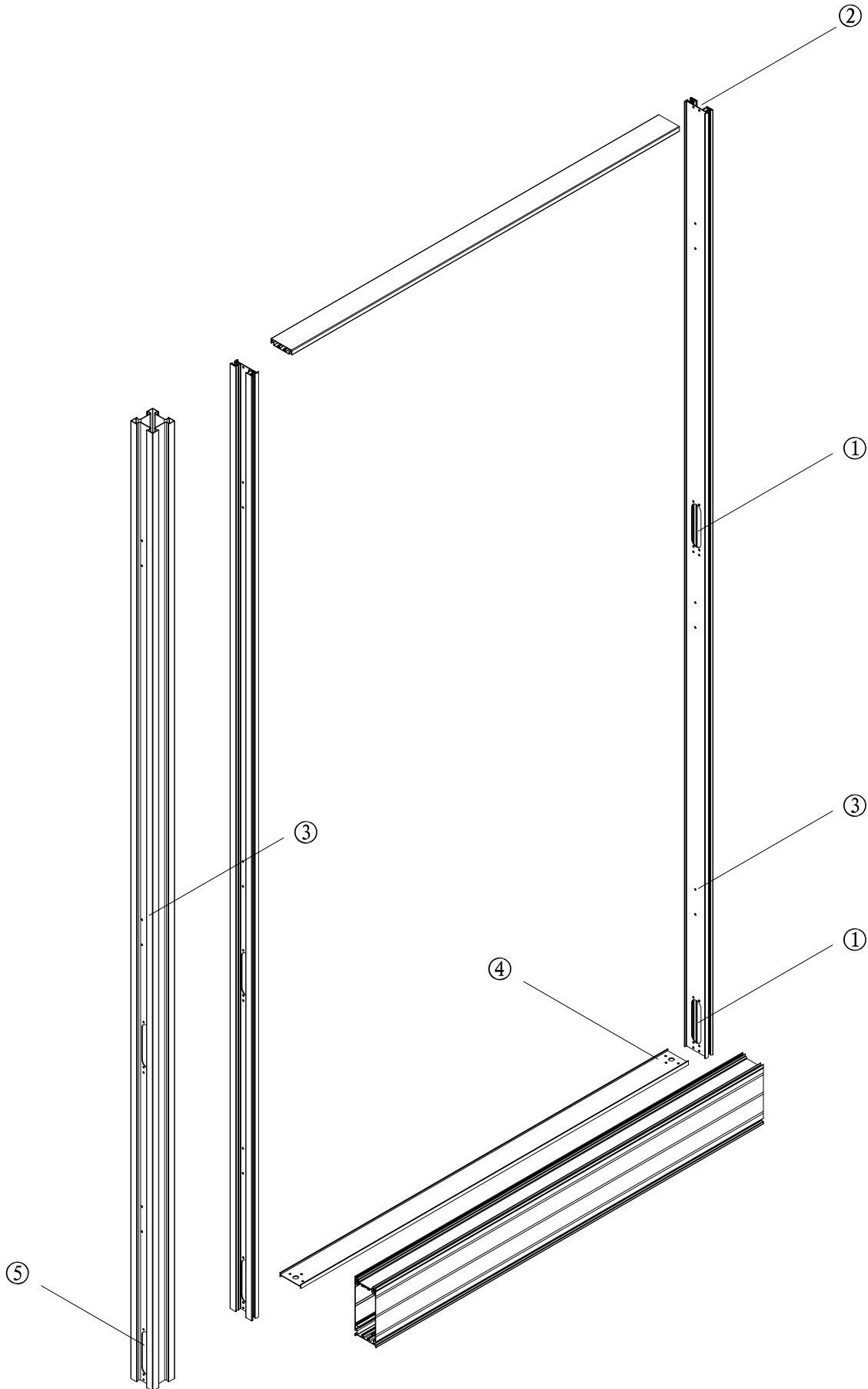

## Holes punching

### ①. A pole wires passing hole

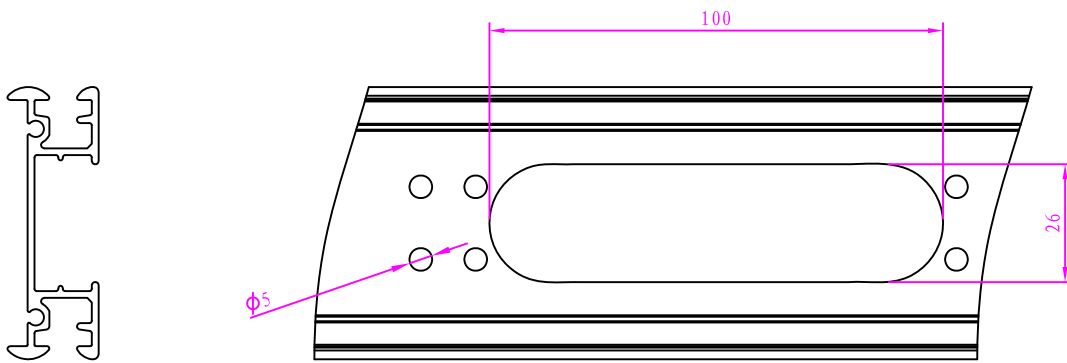

### ②. A pole panels connection holes

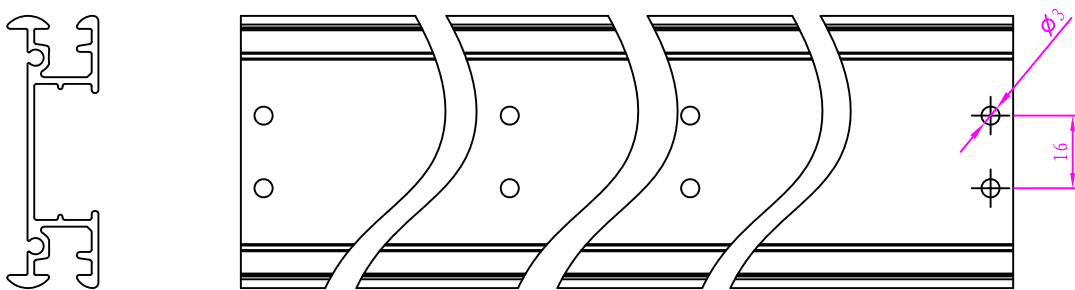

### ③. Bottom bar/cable bottom bar adjusted foot hole

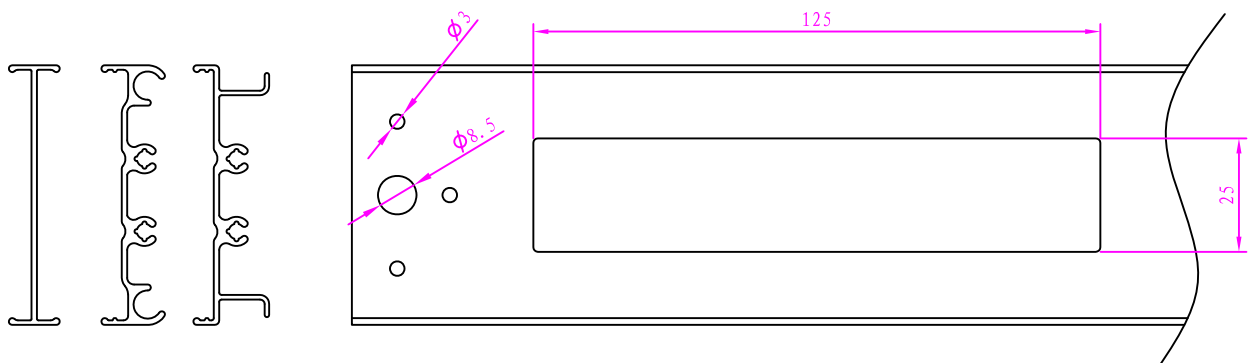

## ④. Square pole wires passing holes

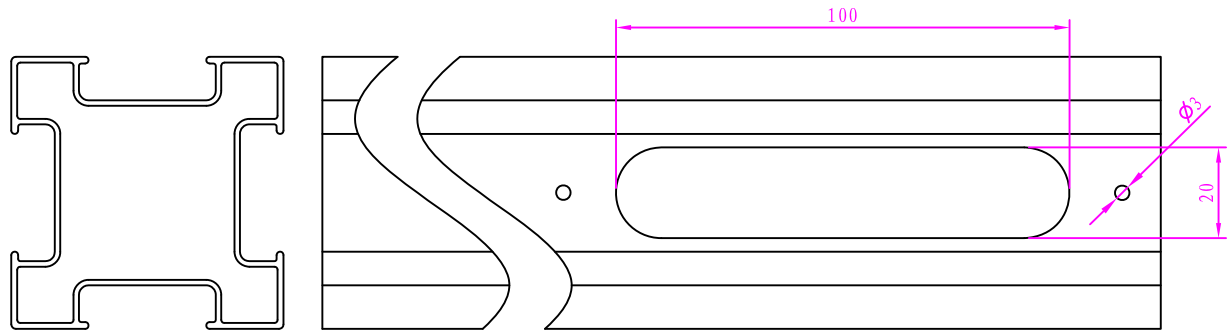

## ⑤. A pole/Square pole panels connectionholes

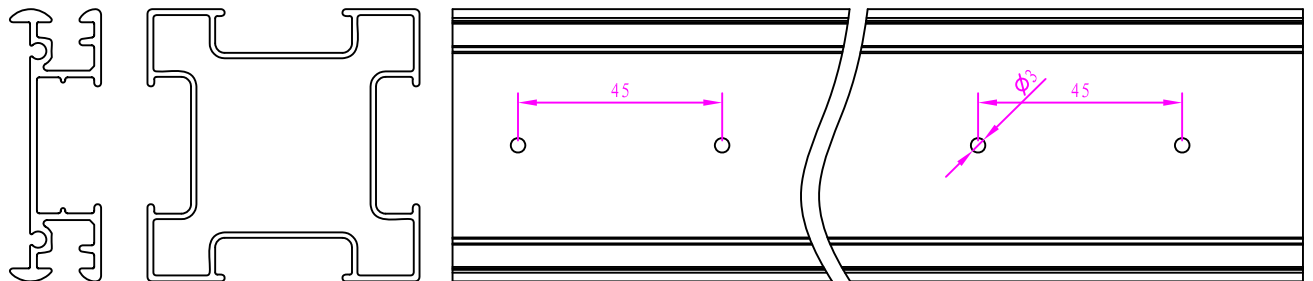



# M & W

**Web:** [mwworkstation.com](http://mwworkstation.com)

**Mail:** [robbor@mwworkstation.com](mailto:robbor@mwworkstation.com)

**Tel:** +86 13695211636

**WhatsApp:** + 86 13695211636

**Add:** NO.3 Xingye North Road Dawotang Industrial  
District Shishan Nanhai Foshan City Guangdong  
P.R China



WhatsApp



Facebook



Instagram



Twitter



Pinterest



Linkein



YouTube