

# M & W

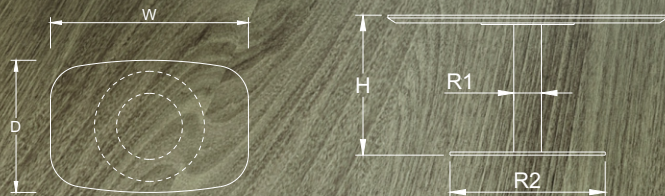

# ROUND TABLE



W	D	H	R1	R2	Code	CBM	G.W(kg)
900	600	450	89	500	DYP-CJ-0906	0.03	31



Diameter	H	R1	R2	Code	CBM	G.W(kg)
∅ 600	750	∅ 89	∅ 500	DYP-XCTZ-06	0.02	28
∅ 800	750	∅ 89	∅ 500	DYP-XCTZ-08	0.04	34
∅ 900	750	∅ 89	∅ 500	DYP-XCTZ-09	0.05	37

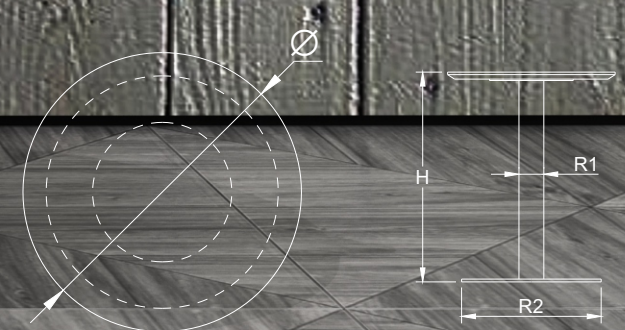

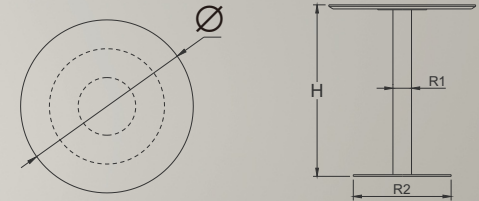

Diameter	H	R1	R2	Code	CBM	G.W(kg)
∅ 900	1050	∅ 114	∅ 600	DYP-GCTZ-09	0.06	46
∅ 1200	1050	∅ 114	∅ 600	DYP-GCTZ-12	0.08	59





迷你时尚家居艺术发展有限公司

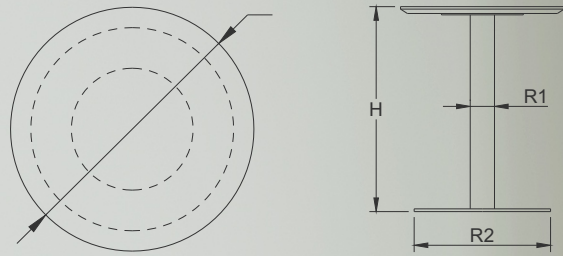

Diameter	H	R1	R2	Code	CBM	G.W(kg)
∅ 600	750	∅89	∅ 500	DYP-XCTZ-06	0.02	28
∅ 800	750	∅89	∅ 500	DYP-XCTZ-08	0.04	34
∅ 900	750	∅89	∅ 500	DYP-XCTZ-09	0.05	37



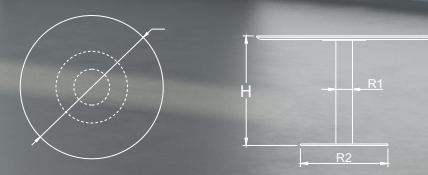

Diameter	H	R1	R2	Code	CBM	G.W <sub>(kg)</sub>
1200	750	∅ 114	∅ 600	DYP-DCTZ-12	0.08	58

### Work Surface Finish Options

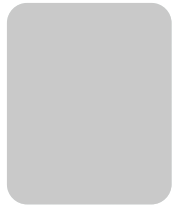

XD-1001(grey)



XD-1004(black)



XD-1008(mini-maple)

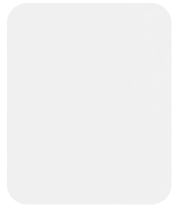

XD-1009(white)



XD-1014(teak)



XD-1016(walnut)



XD-1019(white maple)



XD-1020(maple)



XD-1021(fir)



XD-1022(red oak relieve)



XD-1023(white oak relieve)



XD-1024(technology oak)



XD-1025(black oak relieve)



XD-1026(oak relieve)

### Metal color options

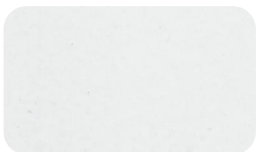

UTOR-13(white)

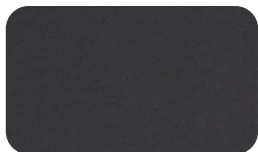

UTOR-06(black)

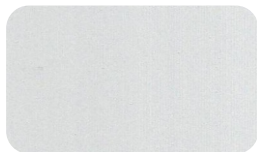

UTOR-05(anodize)

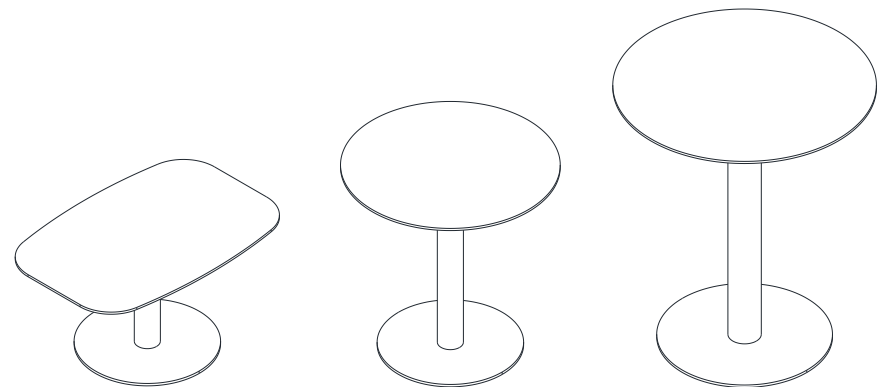
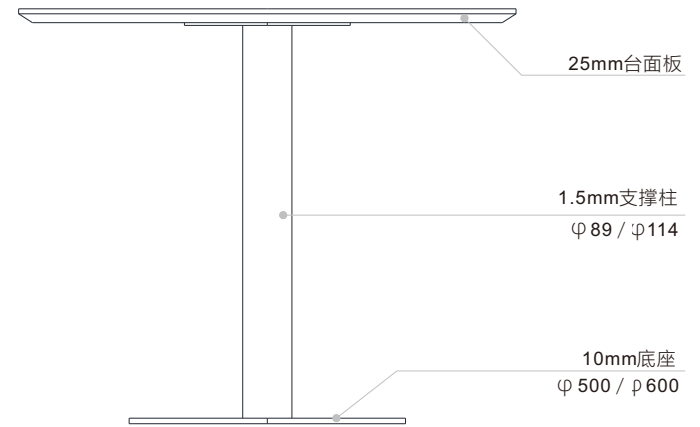

	Code	Base size	Leg height	Table top size	CBM(m <sup>3</sup> )	G.W(kg)
Tea table	DYP-0504	φ 500	425	W900*D600	0.008	20
Meeting table	DYP-0507	φ 500	725	φ 600~φ 900	0.010	21
Meeting table	DYP-0607	φ 600	725	φ 1000~φ 1200	0.016	28
Meeting table	DYP-0610	φ 600	1025	φ 900~φ 1200	0.020	30